

Annex 1 Detailed Plans

0_COVID19_CTC_60to500b > SCALING UP PLAN “Strategy from S to XL”

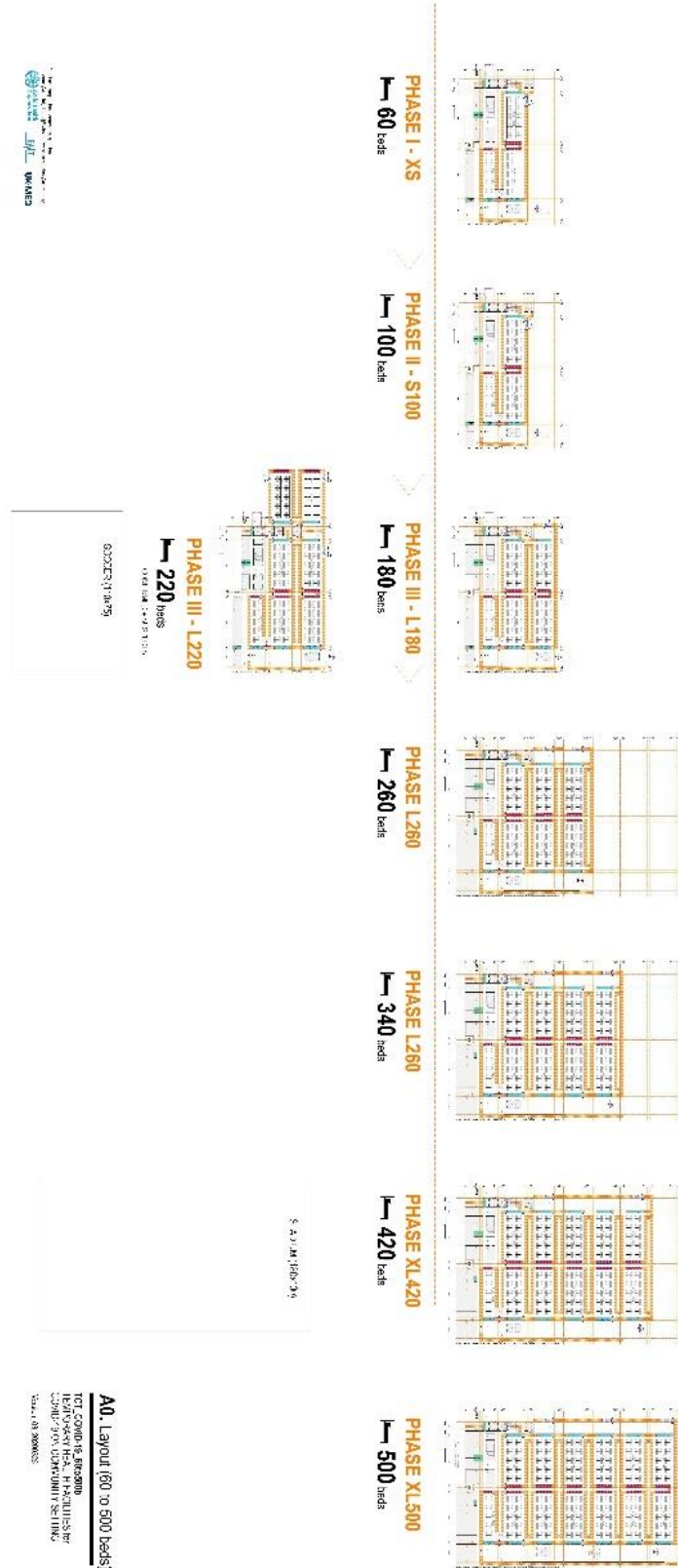

1_COVID19_CTC_S-100b >Alternative PLAN Layout for COVID19 CF 100 Beds



Feedback, suggestions, comments, questions:
 emteams@who.int; durandj@who.int; veronica.sanchez@uk-med.org



CTC-S100

CTC S100 (SMALL SIZE)
 COVID-19 TEMPORARY CENTRE
 IN COMMUNITY FACILITIES
 Version 05 20200412
 e. 1400 - 1600

2_COVID19_CTC_M-180b >Alternative PLAN Layout for COVID19 CF 180 Beds

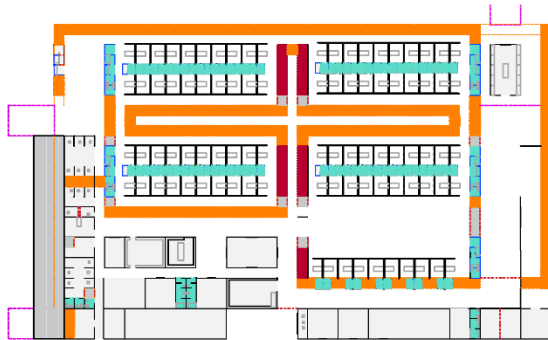

CTC-M180-90s



CTC-M180-40s+100c

- A AMBULANCES
- AD ADMISSION
- CP COORDINATION POINT
- CH CHANGING ROOM
- CR CRASH ROOM
- D DONNING
- DF DOFFING
- E ELECTRICITY
- EW EQUIPMENT WAREHOUSE
- L LABORATORY
- LA LAUNDRY
- MO MORGE
- MP MEETING POINT
- O OFFICE
- PH PHARMACY
- R RECEPTION
- RA REST AREA PATIENTS
- RL REST/LEISURE STAFF
- T TRIAGE
- TA TESTING AREA
- TR TECHNICAL ROOM
- S STORAGE
- SE SECURITY POINT
- SS STORAGE SCRUBS
- STR STERILIZATION ROOM
- SP STORE PPE
- W WAITING ROOM
- WR WAITING RESULTS
- WA WASTE AREA
- WC WC
- WS WATER SUPPLY

- SECURITY DISTANCE (2m)
- ENTRY POINT
- STORE
- WaSH



CTC-M180-180c

Feedback, suggestions, comments, questions:
 emteams@who.int; durandj@who.int; veronica.sanchez@uk-med.org



CTC-M180

CTC M180 (MEDIUM SIZE)
 COVID-19 TEMPORARY CENTRE
 IN COMMUNITY FACILITIES
 Version_05_20200412
 e.1/400 - 1/600

3_COVID19_CTC_L-260b >Alternative PLAN Layout for PLAN Layout for COVID19 CF 260 Beds (suspected area and confirmed area)



Feedback, suggestions, comments, questions:
 emteams@who.int; durandj@who.int; veronica.sanchez@uk-med.org



CTC-L260

CTC L260 (LARGE SIZE)
 COVID-19 TEMPORARY CENTRE
 IN COMMUNITY FACILITIES
 Version 05_20200412
 e. 1400 - 11800

4_COVID19_CTC_XL-500b >Alternative PLAN Layout for PLAN Layout for COVID19 CF 500 Beds

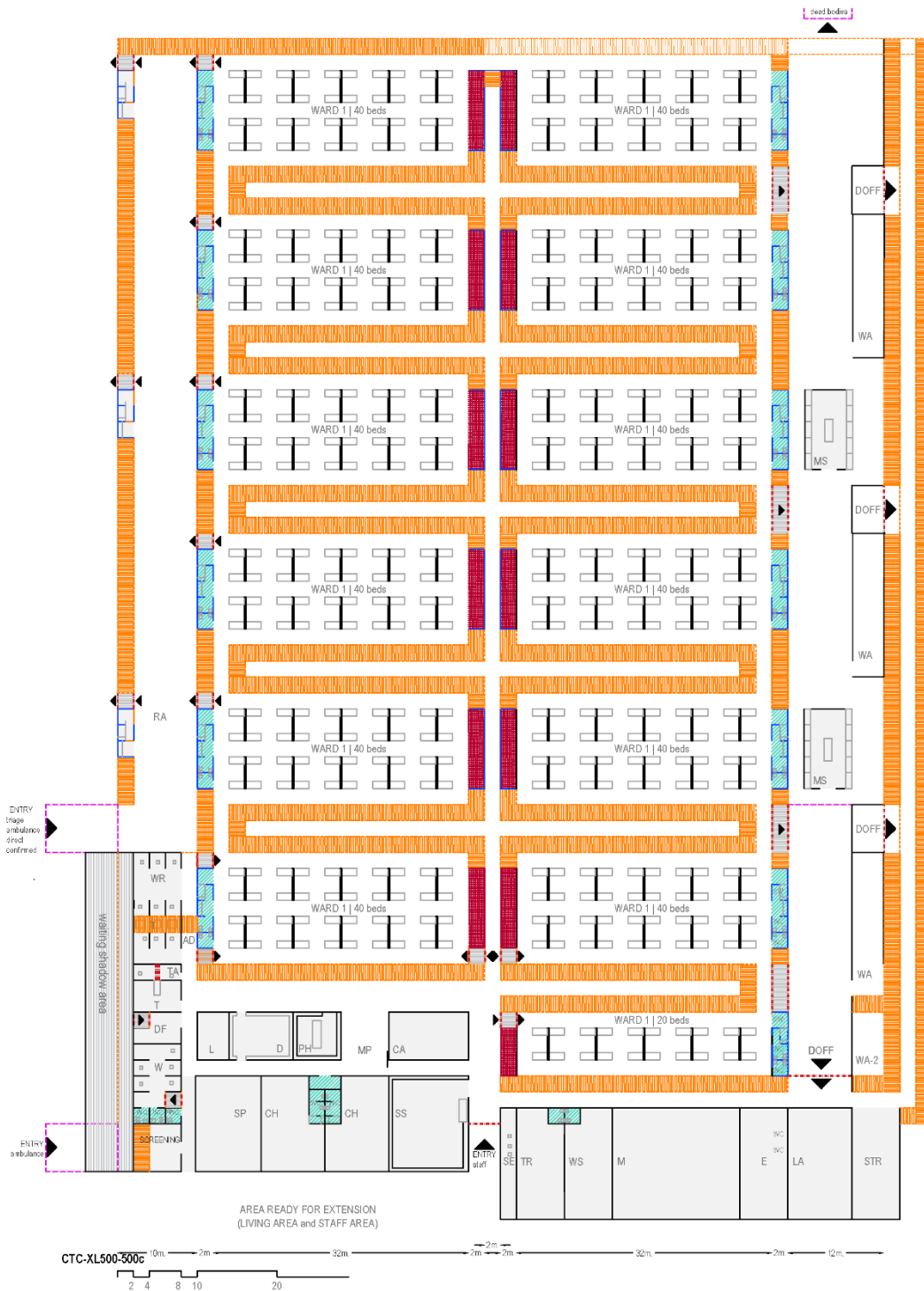

Feedback, suggestions, comments, questions:
 emteams@who.int; durand@who.int; veronica.sanchez@uk-med.org



- SECURITY DISTANCE (2m)
- ENTRY POINT
- STORE
- WaSH

CTC-XL500

CTC_XL500 (EXTRA LARGE SIZE)
 COVID-19 TEMPORARY CENTRE
 IN COMMUNITY FACILITIES
 Version_05_20200412
 e.1450

5_COVID19_CTC_plan-FLOWS> PLAN Layout Patient & STAFF Flows

Flows (Staff, patients, visitors)

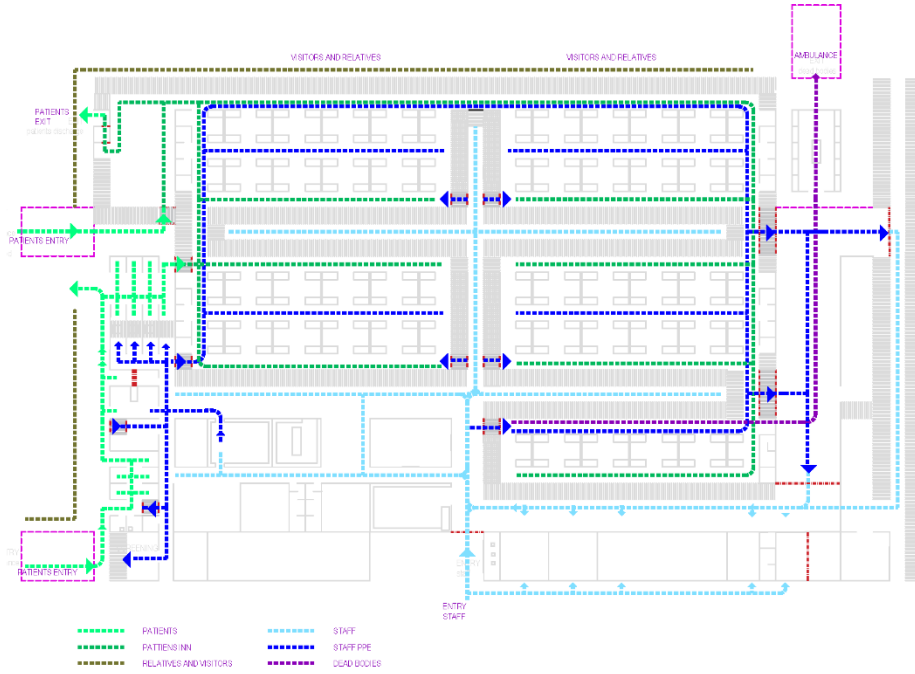

Flows (Waste)



Feedback, suggestions, comments, questions:
 emteams@who.int; durandj@who.int; veronica.sanchez@uk-med.org



F2-FLOWS

CTC L180
 COVID-19 TEMPORARY CENTRE
 IN COMMUNITY FACILITIES
 Version_05_20200412
 e. 1/500

6_COVID19_CTC _ FACILITIES> PLAN FACILITIES

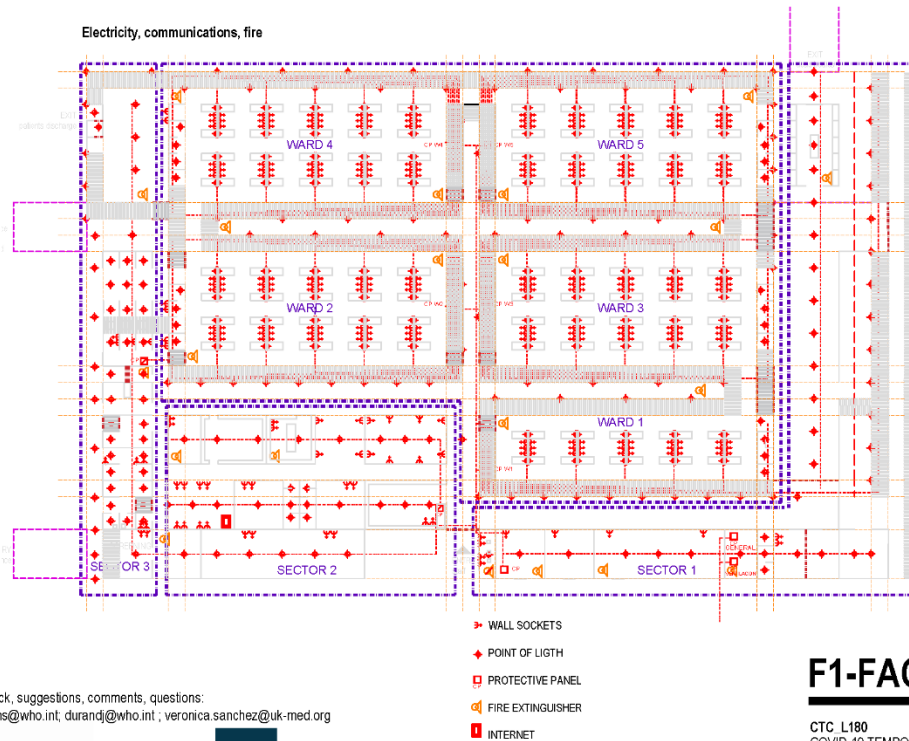
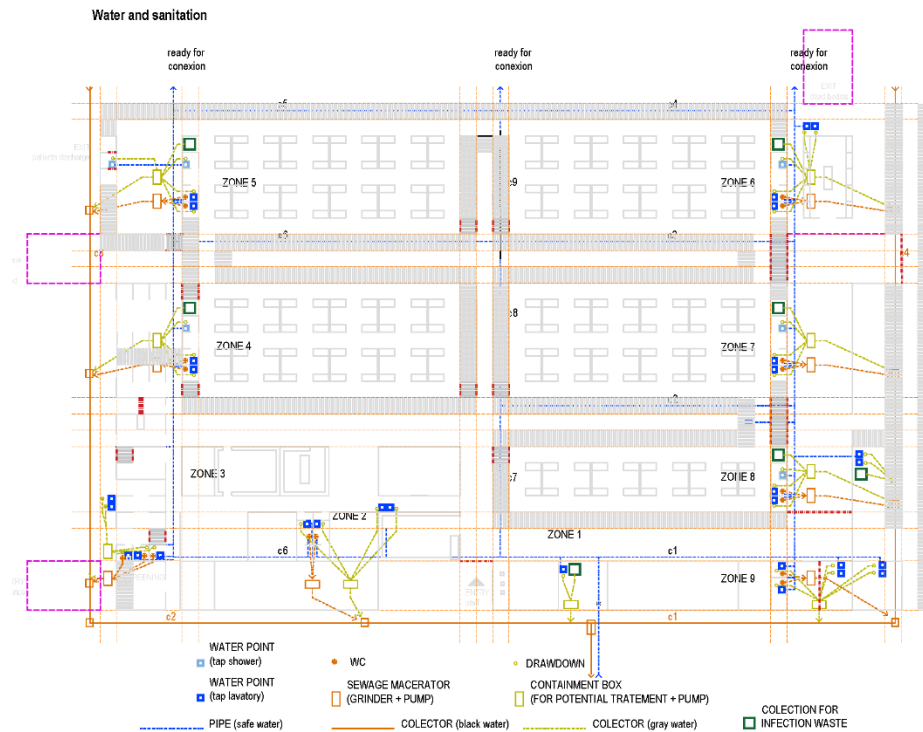

Feedback, suggestions, comments, questions:
 emteams@who.int; durand@who.int; veronica.sanchez@uk-med.org



F1-FACILITIES

CTC L180
 COVID-19 TEMPORARY CENTRE
 IN COMMUNITY FACILITIES
 Version_05_20200412
 e. 1/500

7_COVID19_CTC_STRUCTURES > PLAN STRUCTURES

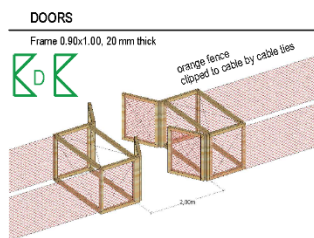
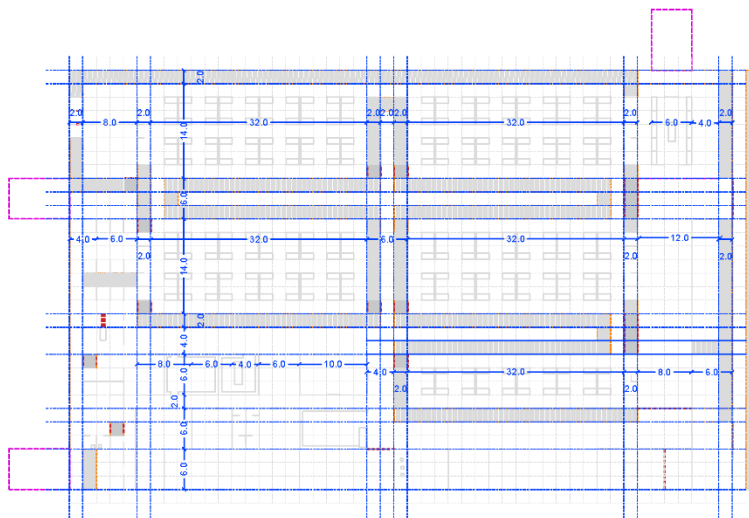
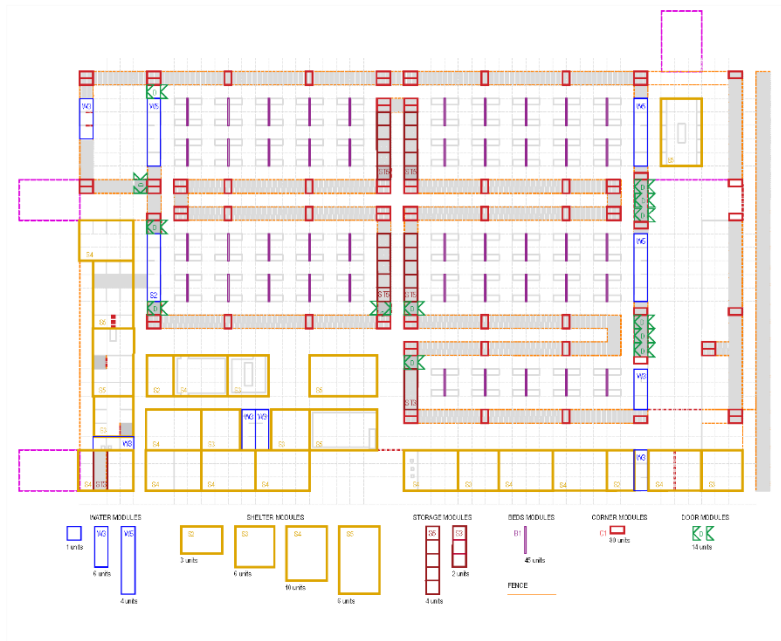

Feedback, suggestions, comments, questions:
 emteams@who.int; durandj@who.int; veronica.sanchez@uk-med.org



CORNER MODULES fences support, lighting support, storage...

- WOODEN VERSION**
- Wooden profiles 80x80mm
 - Steel cable diagonals with turnbuckles

C1

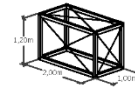

BASIC MODULE

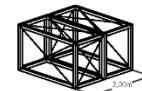

- 2xBASIC MODULES**
shaping the structural module

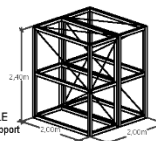

HIGH MODULE for lighting support

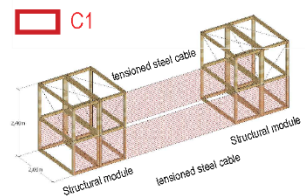

- STEEL VERSION**
- Steel profiles 40x40mm
 - Frames made of welded profiles, screwed together

C1

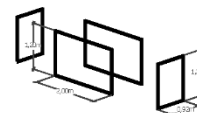
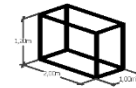

BEDS PANELS: support for facilities

- OSB Panel of standard dimensions (1.22x2.44), 20 mm thick
- Metal angles 30 x 30 cm, 40 cm from the end of the panel.

DOUBLE HEADBOARD with high profiles with hoops on the top to receive electrical cables

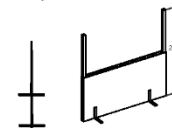
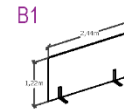

C1-STRUCTURE

CTC L180
 COVID-19 TEMPORARY CENTRE
 IN COMMUNITY FACILITIES
 Version_05_20200412
 e. 1/400

8_COVID19_CTC_-MODULES> Detailed view of WARDS modules

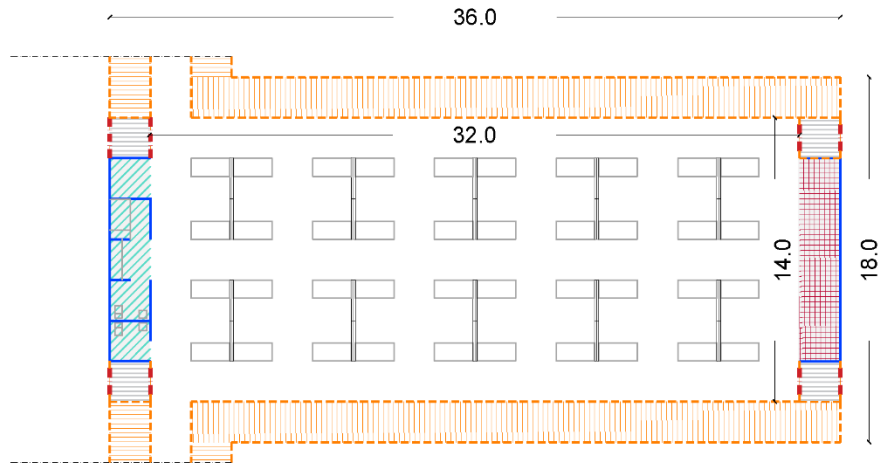

CTC-MODULE 40 (confirmed)

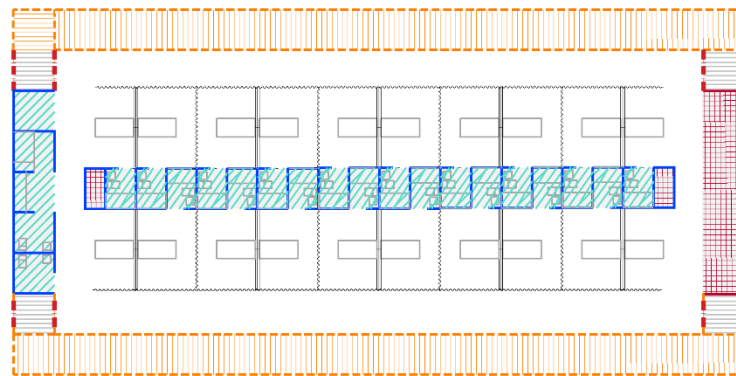

CTC-MODULE 40 (20 suspected)

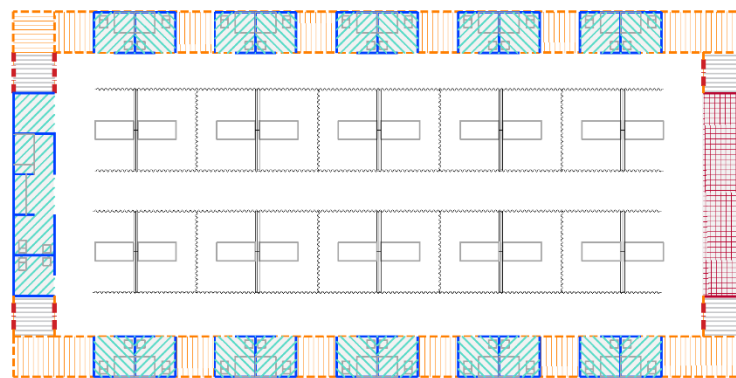





CTC-MODULE 40 (20 suspected)

CTC-MODULE 40 (16 suspected)

Feedback, suggestions, comments, questions:
 emilearns@who.int, durandj@who.int, veronica.sanchez@uk-med.org



-  SECURITY DISTANCE (2m)
-  ENTRY POINT
-  STORE
-  WaSH

CTC-MODULE

CTC_MODULE
 COVID-19 TEMPORARY CENTRE
 IN COMMUNITY FACILITIES
 Version_05_20200412
 e. 1/200

Annex 2 Bill of Quantities

Structures and systems

Source: This publication: **COVID19 community facilities and Treatment Centers**

C1.STRUCTURES		MODEL S 100B	MODEL L 180B	MODEL L 260B	MODEL L 340B	MODEL XL 420B	MODEL XL 500B
ITEM	UNITS	Total Qty	Total Qty	Total Qty	Total Qty	Total Qty	Total Qty
Structure Water Modules W3 (2m x 6m x 2,40m)	Uds.	5	6	7	8	9	10
Structure Water Modules W5 (2m x 10m x 2,40m)	Uds.	2	4	6	8	10	12
Structure Shelter Modules Sh2 (6m x 4m x 2,40m)	Uds.	3	3	3	3	3	3
Structure Shelter Modules Sh3 (6m x 6m x 2,40m)	Uds.	6	6	6	6	6	6
Structure Shelter Modules Sh4 (6m x 8m x 2,40m)	Uds.	7	8	9	10	11	12
Structure Shelter Modules Sh5 (6m x 10m)	Uds.	6	6	6	6	6	6
Structure Storage Module St3 (2m x 6m x 1,20m)	Uds.	2	2	2	2	2	2
Structure Storage Module St5 (2m x 10m x 1,20m)	Uds.	3	4	5	6	7	8
Structure Doors Module (2m x 1,2m - 2 units)	Uds.	8	10	12	14	16	18
Structure Corner module (2m x 1,2m x 1m)	Uds.	28	80	132	184	236	288
Structure Beds Module (1,2m x 2,4m x 0,10m)	Uds.	25	45	65	85	105	125
Fence	m	600	1.000	1.400	1.800	2.200	2.600
Floor (Not considered - To build in existing facility)	m2	5.000	7.000	10.000	12.000	14.000	16.000
Roffing (Not considered - To build in existing facility)	m2	0	0	0	0	0	0
F1.SANITATION		MODEL S 100B	MODEL L 180B	MODEL L 260B	MODEL L 340B	MODEL XL 420B	MODEL XL 500B
ITEM	UNITS	Total Qty	Total Qty	Total Qty	Total Qty	Total Qty	Total Qty
WC Cubicles Superstructure (considering Gender factor)	Uds.	12	16	20	24	28	32
Plastic or resine Latrine slabs 1.20x1.80	Uds.	12	16	20	24	28	32
P-Trap adaptor	Uds.	12	16	20	24	28	32
Commode toilet sit	Uds.	12	16	20	24	28	32
Flexible irrigation hose 3/4 " with nozzle	Uds.	12	16	20	24	28	32
Teflon	rolls	30	40	50	60	70	80
Basin	Uds.	5	7	9	11	13	15
Grease Trap	Uds.	8	10	12	14	16	18
Grey water pump	Uds.	8	10	12	14	16	18
Shower (1 x 20 persons)	Uds.	10	14	18	22	26	30
Macerator	Uds.	7	9	11	13	15	17
32 mm Flexible grey PVC Pipe	lineal mts.	240	300	360	420	480	540
32 mm PVC Gate valve	Uds.	10	12	14	16	18	20
32 mm PVC Tee	Uds.	16	20	24	28	32	36

PVC Glue	tubes	14	18	22	26	30	34
90 mm Rigid PVC pipe	lineal mts.	150	210	270	330	390	450
90 mm Rigid PVC Yee Connection		4	8	12	16	20	24
F1. WATER DISTRIBUTION NETWORK							
ITEM	UNITS	MODEL S 100B	MODEL L 180B	MODEL L 260B	MODEL L 340B	MODEL XL 420B	MODEL XL 500B
		Total Qty	Total Qty	Total Qty	Total Qty	Total Qty	Total Qty
HDPE pipe 25mm	mts	336	560	784	1.008	1.232	1.456
Tee 25 mm	Uds.	22	32	42	52	62	72
Elbow 25mm	Uds.	2	4	6	8	10	12
Gate Valves 25mm	Uds.	28	40	52	64	76	88
Water supply points connections	connec tions	22	28	34	40	46	52
PVC reducer 1"-3/4"	Uds.	22	28	34	40	46	52
PVC pressure tubing 3/4 "	Uds.	22	28	34	40	46	52
PVC ball valves 3/4 "	Uds.	22	28	34	40	46	52
Elbow actioned taps 3/4 "	Uds.	22	28	34	40	46	52
Sink	Uds.	10	16	22	28	34	40
PVC valve, tank outlet 1 1/2 "	Uds.	4	10	16	22	28	34
Tanks HDPE 5000 L	Uds.	4	10	16	22	28	34
Red plastic paint (5Kg)	Uds.	3	4	5	6	7	8
Yellow plastic paint (5Kg)	Uds.	3	4	5	6	7	8
Green plastic paint (5Kg)	Uds.	3	4	5	6	7	8
Teflon	rolls	100	120	140	160	180	200
F2. ELECTRICITY							
ITEM	UNITS	MODEL S 100B	MODEL L 180B	MODEL L 260B	MODEL L 340B	MODEL XL 420B	MODEL XL 500B
		Total Qty	Total Qty	Total Qty	Total Qty	Total Qty	Total Qty
Generator 250 KVA	Uds.	1	1	1	1	1	11
Protective electrical panels	Uds.	8	9	10	11	12	13
Earthing system	Uds.	1	1	1	1	1	45
Cable 2x1.5	m	2.770	3.000	3.230	3.460	3.690	3.920
Cable 3G2.5	m	4.680	5.000	5.320	5.640	5.960	6.280
Cable 5G6	m	200	200	200	200	200	200
Cable 5G16	m	500	500	500	500	500	500
Cable 4x25	Uds.	50	50	50	50	50	50
Staples for cable (100 units box)	Uds.	23	25	27	29	31	33
Connection boxes	Uds.	138	150	162	174	186	198
Connection plugs	Uds.	138	150	162	174	186	198
Wall Sockets	m	560	620	680	740	800	860

LED Lights 10W		120	160	200	240	280	320
Metal tray for cable conduction		160	200	240	280	320	360
F2. TELECOM							
		MODEL S 100B	MODEL L 180B	MODEL L 260B	MODEL L 340B	MODEL XL 420B	MODEL XL 500B
ITEM	UNITS	Total Qty	Total Qty	Total Qty	Total Qty	Total Qty	Total Qty
Radio System	Uds.	1	1	1	1	1	1
Internet System	Uds.	1	1	1	1	1	1
F2. FIRE SAFETY							
		MODEL S 100B	MODEL L 180B	MODEL L 260B	MODEL L 340B	MODEL XL 420B	MODEL XL 500B
ITEM	UNITS	Total Qty	Total Qty	Total Qty	Total Qty	Total Qty	Total Qty
Extinguishers CO2 6Kg	Uds.	18	22	26	30	34	38
Extinguishers ABC powder 6kg	Uds.	2	2	2	2	2	2
F2. VENTILATION							
		MODEL S 100B	MODEL L 180B	MODEL L 260B	MODEL L 340B	MODEL XL 420B	MODEL XL 500B
ITEM	UNITS	Total Qty	Total Qty	Total Qty	Total Qty	Total Qty	Total Qty
Individual ventilators		100	180	260	260	420	500
Portable HEPA filtration units		3	5	7	7	11	13
F4. WASTE MANAGEMENT							
		MODEL S 100B	MODEL L 180B	MODEL L 260B	MODEL L 340B	MODEL XL 420B	MODEL XL 500B
ITEM	UNITS	Total Qty	Total Qty	Total Qty	Total Qty	Total Qty	Total Qty
Pedal opening Bins 30 l(Infectious waste)	Uds.	22	30	38	46	54	62
Bio-hazardous bag	Uds.	1.500	2.000	2.500	3.000	3.500	4.000
IPC Box 3 l (Sharp waste)	Uds.	8	10	12	14	16	18
IPC Bins 30 l(General waste)	Uds.	9	10	11	12	13	14
IPC Wheeled bins 120 l (3 colors)	Uds.	3	3	3	3	3	3
IPC Bucket for disinfection 120L	Uds.	2	2	2	2	2	2
Pressure washer	Uds.	1	1	1	1	1	1
F4.HYGIENE AND ENV CLEANING							
		MODEL S 100B	MODEL L 180B	MODEL L 260B	MODEL L 340B	MODEL XL 420B	MODEL XL 500B
ITEM	UNITS	Total Qty	Total Qty	Total Qty	Total Qty	Total Qty	Total Qty
Liquid soap dispensers	Uds.	10	16	22	28	34	40
Liquid soap	Uds.	70	90	110	130	150	170
Alcohol-based hand rub	Uds.	60	108	156	204	252	300
Chlorine, NADCC 65%	Uds.	40	60	80	100	120	140
IPC Bucket for laundry 120 L	Uds.	8	12	16	20	24	28
IPC Bucket for washing 15 L	Uds.	6	10	14	18	22	26
IPC Sprayers 10 L	Uds.	3	4	5	6	7	8
IPC Body Bags	Uds.	10	40	70	100	130	160

IPC Mope	Uds.	4	6	8	10	12	14
F4. EQUIPMENT AND FURNITURE							
		MODEL S 100B	MODEL L 180B	MODEL L 260B	MODEL L 340B	MODEL XL 420B	MODEL XL 500B
ITEM	UNITS	Total Qty	Total Qty	Total Qty	Total Qty	Total Qty	Total Qty
Medical equipment X-Ray	Uds.	2	2	2	2	2	2
Furniture Tables	Uds.	6	8	10	12	14	16
Furniture Chairs	Uds.	40	50	60	70	80	90
Furniture Mirrors	Uds.	19	21	23	25	27	29
Furniture Clocks	Uds.	8	10	12	14	16	18
Furniture Benches	Uds.	6	6	6	6	6	6
Furniture Shelves	Uds.	12	12	12	12	12	12
Furniture Beds	Uds.	102	182	262	342	422	502
Sing post	Uds.	36	40	44	48	52	56

C1.STRUCTURES		WARD MODULE SUSPECTED 20 Beds	WARD MODULE CONFIRMED 20 Beds	CORE AREA +20 SICA Beds
ITEM	UNITS	Total Qty	Total Qty	Total Qty
Structure Water Modules W1 (2m x 1,5r x 2,40m)		20	0	4
Structure Water Modules W3 (2m x 6m x 2,40m)	Uds.	1	1	0
Structure Water Modules W5 (2m x 10m x 2,40m)	Uds.	0	0	4
Structure Shelter Modules Sh2 (6m x 4m x 2,40m)	Uds.	0	0	6
Structure Shelter Modules Sh3 (6m x 6m x 2,40m)	Uds.	0	0	6
Structure Shelter Modules Sh4 (6m x 8m x 2,40m)	Uds.	0	0	6
Structure Shelter Modules Sh5 (6m x 10m)	Uds.	0	0	2
Structure Storage Module St3 (2m x 6m x 1,20m)	Uds.	0	0	2
Structure Storage Module St5 (2m x 10m x 1,20m)	Uds.	1	1	6
Structure Doors Module (2m x 1,2m - 2 units)	Uds.	2	2	-24
Structure Corner module (2m x 1,2m x 1m)	Uds.	14	14	5
Structure Beds Module (1,2m x 2,4m x 0,10m)	Uds.	10	10	200
Fence	m	220	220	3.000
Floor (Not considered - To build in existing facility)	m2	648	648	3.000
Roofing (Not considered - To build in existing facility)	m2	648	648	0

F1.SANITATION		WARD MODULE SUSPECTED 20 Beds	WARD MODULE CONFIRMED 20 Beds	CORE AREA +20 SICA Beds
ITEM	UNITS	Total Qty	Total Qty	Total Qty
WC Cubicles Superstructure (considering Gender factor)	Uds.	20	2	8
Plastic or resine Latrine slabs 1.20x1.80	Uds.	20	2	8
P-Trap adaptor	Uds.	20	2	8
Commode toilet sit	Uds.	20	2	8
Flexible irrigation hose 3/4 " with nozzle	Uds.	20	2	8
Teflon	rolls	12	2	20
Basin	Uds.	20	2	3
Grease Trap	Uds.	2	1	6
Grey water pump	Uds.	1	1	6
Shower (1 x 20 persons)	Uds.	20	1	6
Macerator	Uds.	1	1	5
32 mm Flexible grey PVC Pipe	lineal mts.	240	60	180
32 mm PVC Gate valve	Uds.	4	2	8
32 mm PVC Tee	Uds.	4	2	12
PVC Glue	tubes	16	2	10
90 mm Rigid PVC pipe	lineal mts.	100	25	90
90 mm Rigid PVC Yee Connection		18	4	0
F1. WATER DISTRIBUTION NETWORK		WARD MODULE SUSPECTED 20 Beds	WARD MODULE CONFIRMED 20 Beds	CORE AREA +20 SICA Beds
ITEM	UNITS	Total Qty	Total Qty	Total Qty
HDPE pipe 25mm	mts	140	112	112
Tee 25 mm	Uds.	22	5	12
Elbow 25mm	Uds.	2	2	0
Gate Valves 25mm	Uds.	22	6	16
Water supply points connections	connections	22	3	16
PVC reducer 1"-3/4"	Uds.	22	3	16
PVC pressure tubing 3/4 "	Uds.	22	3	16
PVC ball valves 3/4 "	Uds.	22	3	16
Elbow actioned taps 3/4 "	Uds.	22	3	16
Sink	Uds.	22	3	4
PVC valve, tank outlet 1 1/2 "	Uds.	0	0	-2
Tanks HDPE 5000 L	Uds.	0	0	-2

Red plastic paint (5Kg)	Uds.	0	0	2
Yellow plastic paint (5Kg)	Uds.	0	0	2
Green plastic paint (5Kg)	Uds.	0	0	2
Teflon	rolls	48	12	80
F2. ELECTRICITY		WARD MODULE SUSPECTED 20 Beds	WARD MODULE CONFIRMED 20 Beds	CORE AREA +20 SICA Beds
ITEM	UNITS	Total Qty	Total Qty	Total Qty
Generator 250 KVA	Uds.	0	0	1
Protective electrical panels	Uds.	1	1	7
Earthing system	Uds.	0	0	1
Cable 2x1.5	m	115	115	2.540
Cable 3G2.5	m	160	160	4.360
Cable 5G6	m	0	0	200
Cable 5G16	m	0	0	500
Cable 4x25	Uds.	0	0	50
Staples for cable (100 units box)	Uds.	1	1	21
Connection boxes	Uds.	6	6	126
Connection plugs	Uds.	6	6	126
Wall Sockets	m	30	40	500
LED Lights 10W		20	20	80
Metal tray for cable conduction		20	20	120
F2. TELECOM		WARD MODULE SUSPECTED 20 Beds	WARD MODULE CONFIRMED 20 Beds	CORE AREA +20 SICA Beds
ITEM	UNITS	Total Qty	Total Qty	Total Qty
Radio System	Uds.	0	0	1
Internet System	Uds.	0	0	1
F2. FIRE SAFETY		WARD MODULE SUSPECTED 20 Beds	WARD MODULE CONFIRMED 20 Beds	CORE AREA +20 SICA Beds
ITEM	UNITS	Total Qty	Total Qty	Total Qty
Extinguishers CO2 6Kg	Uds.	2	2	14
Extinguishers ABC powder 6kg	Uds.	0	0	2
F2. VENTILATION		WARD MODULE SUSPECTED 20 Beds	WARD MODULE CONFIRMED 20 Beds	CORE AREA +20 SICA Beds
ITEM	UNITS	Total Qty	Total Qty	Total Qty
Individual ventilators		20	40	20

Portable HEPA filtration units		2	1	1
F4. WASTE MANAGEMENT		WARD MODULE SUSPECTED 20 Beds	WARD MODULE CONFIRMED 20 Beds	CORE AREA +20 SICA Beds
ITEM	UNITS	Total Qty	Total Qty	Total Qty
Pedal opening Bins 30 l(Infectious waste)	Uds.	4	4	14
Bio-hazardous bag	Uds.	250	250	1.000
IPC Box 3 l (Sharp waste)	Uds.	2	2	6
IPC Bins 30 l(General waste)	Uds.	0	0	8
IPC Wheeled bins 120 l (3 colors)	Uds.	0	0	3
IPC Bucket for disinfection 120L	Uds.	0	0	2
Pressure washer	Uds.	0	0	1
F4.HYGIENE AND ENV CLEANING		WARD MODULE SUSPECTED 20 Beds	WARD MODULE CONFIRMED 20 Beds	CORE AREA +20 SICA Beds
ITEM	UNITS	Total Qty	Total Qty	Total Qty
Liquid soap dispensers	Uds.	20	3	4
Liquid soap	Uds.	10	10	50
Alcohol-based hand rub	Uds.	24	24	12
Chlorine, NADCC 65%	Uds.	10	10	20
IPC Bucket for laundry 120 L	Uds.	2	2	4
IPC Bucket for washing 15 L	Uds.	2	2	2
IPC Sprayers 10 L	Uds.	1	1	2
IPC Body Bags	Uds.	10	10	-20
IPC Mope	Uds.	1	1	2
F4. EQUIPMENT AND FURNITURE		WARD MODULE SUSPECTED 20 Beds	WARD MODULE CONFIRMED 20 Beds	CORE AREA +20 SICA Beds
ITEM	UNITS	Total Qty	Total Qty	Total Qty
Medical equipment X-Ray	Uds.	0	0	2
Furniture Tables	Uds.	1	1	4
Furniture Chairs	Uds.	20	5	30
Furniture Mirrors	Uds.	1	1	17
Furniture Clocks	Uds.	1	1	6
Furniture Benches	Uds.	0	0	6
Furniture Shelves	Uds.	0	0	12
Furniture Beds	Uds.	20	40	22
Sing post	Uds.	2	2	32

PPE Personal Protective Equipment and scrubs

Source: **Severe Acute Respiratory Infections Treatment Centre**; Practical manual to set up and manage a SARI treatment centre and a SARI screening facility in health care facilities, WHO, March 2020

A1 MODULE, PPE		MODEL S 100B	MODEL L 180B	MODEL L 260B	MODEL L 340B	MODEL XL 420B	MODEL XL 500B
WHO Code	WHO Description	Qty kit nCoV 100 patients	Qty kit nCoV 180 patients	Qty kit nCoV 260 patients	Qty kit nCoV 340 patients	Qty kit nCoV 420 patients	Qty kit nCoV 500 patients
YMEQGLASWSI--AI	GOGGLES PROTECTIVE, wraparound, soft frame, indirectvent.	300	540	780	1020	1260	1500
PEXTALCOIG---AI	ALCOHOL-BASED HAND RUB,gel, 100m L, bottle	60	108	156	204	252	300
EWASBAGBR007 -AI	BAG BIOHAZARD, REFUSE,AUTOCLAVABLE , 30x50cm, yellow	100	180	260	340	420	500
EWASYCHN5GI--AI	CHLORINE NaDCC, 45-55%,gran., lkg, pot	8	15	21	28	34	40
CPPEGOWI3L---AI	GOWN,AAMI level 3, non sterile, disp., size L	540	972	1404	1836	2268	2700
CPPEGOWI3M ---AI	GOWN,AAMI level 3, non sterile, disp., size M	630	1134	1638	2142	2646	3150
CPPEGOWI3XL--AI	GOWN,AAMI level 3, non sterile, disp., size XL	450	810	1170	1530	1890	2250
CPPEGOWI3XXL-AI	GOWN,AAMI level 3, non sterile, disp., size XXL	180	324	468	612	756	900
CMSUGLENILI--AI	GLOVE EXAMINATION, nitrile, pi, size L	2200	3960	5720	7480	9240	11000
CMSUGLENIMI--AI	GLOVE EXAMINATION, nitrile, pi, size M	4200	7560	10920	14280	17640	21000
CMSUGLENISI--AI	GLOVE EXAMINATION, nitrile, pi, size S	4200	7560	10920	14280	17640	21000
CMSUGLENIXL--AI	GLOVE EXAMINATION, nitrile, pi, size XL	1600	2880	4160	5440	6720	8000
CPPEMASS2RL--AI	MASKSURGICAL, type IIR, level 2, s.u, non sterile, earloop, size L	1100	1980	2860	3740	4620	5500
CPPEMASS2RM--AI	MASKSURGICAL, type IIR, level 2, s.u, non sterile, earloop, size M	1100	1980	2860	3740	4620	5500
CPPEMASS2RS--AI	MASKSURGICAL,type IIR, level 2, s.u, non sterile, earloop, size S	1100	1980	2860	3740	4620	5500
CPPEMASPF205-AI	RESPIRATOR,mask, FFP2/N95, type IIR, s.u., unvalved,nosedip	6000	10800	15600	20400	25200	30000
CPPEFSHIE002-AI	FACESHIELD,clear plastic, disp.	2700	4860	7020	9180	11340	13500
CMSUTHERIOI--AI	THERMOMETER, INFRARED, no contact, handheld	30	54	78	102	126	150
CINSCONTC51--AI	SAFETY BOX, needles/syringes,51, cardboard for incineration	40	72	104	136	168	200
OPACUN62BS1--AI	BOX, triple packaging, biological substance UN3373 +pouch	100	180	260	340	420	500
OPACUN621SI--AI	BOX, triple packaging, infectious substance UN2814	20	36	52	68	84	100
CMSUBAGB4A04-AI	BAG BODY, 8handles, U-shaped zip, white,400 microns, adult, 230x100cm	20	36	52	68	84	100
KIT Staff MODULE, Uniform x 4 shift		MODEL S 100B	MODEL L 180B	MODEL L 260B	MODEL L 340B	MODEL XL 420B	MODEL XL 500B
WHO Code	WHO Description	Qty kit nCoV 50 Staff	Qty kit nCoV 80 Staff	Qty kit nCoV 112 Staff	Qty kit nCoV 142 Staff	Qty kit nCoV 172 Staff	Qty kit nCoV 200 staff
YPESTUTROSS-AI	SET, TUNIC + TROUSERS SURGICAL. woven,reusable,green, size [S]	50	80	112	142	172	200
YPESTUTROSMAI	SET, TUNIC+ TROUSERS SURGICAL. woven, reusable,green, size [M]	88	140	196	249	301	350
YPESTUTROSLSAI	SET,TUNIC+ TROUSERS SURGICAL. woven,reusable,green, size [L]	75	120	168	213	258	300
YPESTUTROSXLAI	SET, TUNIC+ TROUSERS SURGICAL. woven, reusable,green, size [XL]	38	60	84	107	129	150
OUFBOOTW38--AI	BOOTS, rubber,size (38),dark color (green or black), pair	32	50	70	89	108	125
OUFBOOTW40--A1	BOOTS, rubber,size (40),dark color (green or black), pair	63	100	140	178	215	250
OLIFBOOTW42--AI	BOOTS, rubber,size (42),dark color (green or black), pair	50	80	112	142	172	200
OUFBOOTW44--AI	BOOTS, rubber, size (44), dark color (green or black), pair	38	60	84	107	129	150
OLIFBOOTW46--A1	BOOTS, rubber,size (46),dark color (green or black), pair	19	30	42	54	65	75
KIT nCoV Hygienist staffs MODULE x 4 shift Uniform and PPE		MODEL S 100B	MODEL L 180B	MODEL L 260B	MODEL L 340B	MODEL XL 420B	MODEL XL 500B
WHO Code	WHO Description	Qty kit nCoV 12 Staff	Qty kit nCoV 16 Staff	Qty kit nCoV 20 Staff	Qty kit nCoV 24 Staff	Qty kit nCoV 28 Staff	Qty kit nCoV 32 Staff

YPPESTUTROSS-AI	SET, TUNIC + TROUSERS SURGICAL. woven, reusable, green, size [S]	12	16	20	24	28	32
YPPESTUTROSM-AI	SET, TUNIC+ TROUSERS SURGICAL. woven, reusable, green, size [M]	21	28	35	42	49	56
YPPESTUTROSL-AI	SET, TUNIC+ TROUSERS SURGICAL. woven, reusable, green, size [L]	18	24	30	36	42	48
YPPESTUTROSLAI	SET, TUNIC+ TROUSERS SURGICAL. woven, reusable, green, size [XL]	9	12	15	18	21	24
OUFBOOTW38--AI	BOOTS, rubber, size (38), dark color (green or black), pair	8	10	13	15	18	20
OUFBOOTW40--A1	BOOTS, rubber, size (40), dark color (green or black), pair	15	20	25	30	35	40
OLIFBOOTW42--AI	BOOTS, rubber, size (42), dark color (green or black), pair	12	16	20	24	28	32
OUFBOOTW44--AI	BOOTS, rubber, size (44), dark color (green or black), pair	9	12	15	18	21	24
OLIFBOOTW46--A1	BOOTS, rubber, size (46), dark color (green or black), pair	5	6	8	9	11	12
CPPEMASPF205-AI	RESPIRATOR, mask, FFP2/N95, type IIR, s.u., unvalved, nosedip	48	64	80	96	112	128
YMEQGLASWSI--AI	GOGGLES PROTECTIVE, wraparound, soft frame, indirectvent.	48	64	80	96	112	128
	APRON, disposable	1440	1920	2400	2880	3360	
	APRON HEAVY DUTY, reusable	48	64	80	96	112	

Medical Equipment

Source: **Electro-mechanical medical equipment for NCoV Case Management WHE / OSL V 1.0)**

KIT COVID-19 MODULE MEDICAL EQUIPMENT									
Medical Area	Medical Purpose		Type	Designation (EN)	Variable	Per bed	Per case	MODEL S 100B	Each increase of 80 Moderate Beds
Severe	Monitoring	Patient Monitor	Equipment	MONITOR PATIENT, NIBP, w/o ECG, battery, trolley, +acc.	Per bed	1		80	80
Severe	Oxygen therapy	Pulse Oximeter	Equipment	PULSE OXYMETER - FINGERTIP	Per bed	0,8		64	65
Severe	Oxygen therapy	Concentrator O2	Equipment	CONCENTRATOR O2 10L, 230V, 50 Hz + acc.	Per bed	1		80	81
Severe	Oxygen therapy	Concentrator O2	Accessories	(humidifier) HOSE CONNECTOR	Per equipment			8	9
Severe	Oxygen therapy	Concentrator O2	Accessories	HUMIDIFIER, autoclavable	Per equipment			8	9
Severe	Oxygen therapy	Concentrator O2	Accessories	(concentr.O2) FLOW SPLITTER pediat., 5 flowmeters 0-2L/min	Per equipment			8	9
Severe	Oxygen therapy	Concentrator O2	Consumables	NASAL OXYGEN CANNULA, 2.1m, 2 prongs + tube, adult	Per case		0,8	92	92
Severe	Oxygen therapy	Concentrator O2	Consumables	NASAL OXYGEN CANNULA, 2 prongs + tube, paediatric	Per case		0,15	18	17
Severe	Oxygen therapy	Concentrator O2	Consumables	NASAL OXYGEN CANNULA, 2 prongs + tube, neonate	Per case		0,05	6	6

Severe	Oxygen therapy	Concentrator O2	Consumables	Mask, oxygen, with connection tube, reservoir bag and valve, high-concentration, adult, non-sterile, single use	Per case		0,8	92	92
Severe	Oxygen therapy	Concentrator O2	Consumables	Mask, oxygen, with connection tube, reservoir bag and valve, high-concentration, paediatric, non-sterile, single use	Per case		0,15	18	17
Severe	Oxygen therapy	Concentrator O2	Consumables	Venturi Mask, with percent O2 Lock + 2.1 m tubing , adult	Per case		0,8	92	92
Severe	Oxygen therapy	Concentrator O2	Consumables	Venturi Mask, with percent O2 Lock + 2.1 m tubing , paediatric	Per case		0,15	18	17
Severe	Oxygen therapy	Concentrator O2	Consumables	Catheter, nasal, 8 Fr, 40 cm, with lateral eyes, sterile, single use	Per case		0,8	92	92
Severe	Oxygen therapy	Concentrator O2	Consumables	CONNECTOR, biconical, symmetric, ext. diam.7-11 mm, autoclav.	Per case		1	115	114
Severe	Oxygen therapy	Concentrator O2	Consumables	TUBE, silicone, autoclavable, int. diam.5 mm, 25 m	Per case		2	229	229
Severe	Oxygen therapy	O2 Wall	Equipment	Flowmeter, Thorpe tube, for oxygen 0-15L/min	Per bed	2		160	161
Severe	Oxygen therapy	CPAP, infant	Equipment	CPAP 10 machine, w/twin flowmeters	Per bed	0,01		1	1
Severe	Oxygen therapy	CPAP, adult	Equipment	CPAP unit w/nasal tubing and mask for adult	Per bed	0,08		7	6
Severe	Oxygen therapy	Suction Pump	Equipment	SUCTION PUMP, MECHANICAL + collection bottles	Per centre			12	0
Severe	Oxygen therapy	Suction Pump	Consumables	TUBE, silicone, autoclavable, int. diam.8 mm, 10 m	Per case		0,025	3	3
Severe	Drug administration	Drop Counter	Equipment	ELECTRONIC DROP COUNTER, IV fluids infu. gravity monitor, alarm, batt.AA	Per bed	1		80	81
Severe	Blood Chemistry	Chemistry Analyser	Equipment	CLINICAL CHEMISTRY ANALYSER	Per centre			3	0
Severe	Blood Chemistry	Chemistry Analyser	Consumables	CARTRIDGE for Chemistry analyser (lactic acidosis and hyperlactatemia)	Per case		2	229	229
Severe	Blood Chemistry	Chemistry Analyser	Consumables	CARTRIDGE (metabolic status and renal function)	Per case		1	115	114
Severe	Blood Chemistry	Chemistry Analyser	Consumables	CONTROL,solution 1	Per equipment			6	0
Severe	Blood Chemistry	Chemistry Analyser	Consumables	CONTROL,solution 2	Per equipment			6	0
Severe	Blood Chemistry	Chemistry Analyser	Consumables	CONTROL,solution 3	Per equipment			6	0
Severe	Blood Chemistry	Chemistry Analyser	Consumables	TUBE, VACUUM, plastic, Li-HEPARIN, 2 mL green	Per case		2	229	229
Severe	Blood Chemistry	Chemistry Analyser	Consumables	TUBE, VACUUM, plastic, Li-HEPARIN, 4 mL green	Per case		2	229	229
ICU	Monitoring	Patient Monitor	Equipment	MONITOR PATIENT, multiparamet, ECG/CAPNO/SpO2/NIBP/Temp,2 30V,+acc	Per bed	1		20	N/a
ICU	Monitoring	Patient Monitor	Consumables	(ECG) ELECTRODE GEL, bottle	Per case		0,05	3	N/a
ICU	Oxygen therapy	Pulse Oximeter	Equipment	PULSE OXYMETER - FINGERTIP	Per bed	0,8		16	N/a
ICU	Oxygen therapy	Concentrator O2	Equipment	CONCENTRATOR O2 10L, 230V, 50 Hz + acc.	Per bed	1		20	N/a
ICU	Oxygen therapy	Concentrator O2	Accessories	(humidifier) HOSE CONNECTOR 9/16	Per equipment			2	N/a
ICU	Oxygen therapy	Concentrator O2	Accessories	HUMIDIFIER, autoclavable	Per equipment			2	N/a
ICU	Oxygen therapy	Concentrator O2	Accessories	(concentrator O2) FLOW SPLITTER pediat., 5 flowmeters 0-2L/min	Per equipment			2	N/a
ICU	Oxygen therapy	Concentrator O2	Consumables	NASAL OXYGEN CANNULA, 2.1m, 2 prongs + tube, adult	Per case		0,8	35	N/a
ICU	Oxygen therapy	Concentrator O2	Consumables	NASAL OXYGEN CANNULA, 2 prongs + tube, paediatric	Per case		0,15	7	N/a
ICU	Oxygen therapy	Concentrator O2	Consumables	NASAL OXYGEN CANNULA, 2 prongs + tube, neonate	Per case		0,05	3	N/a

ICU	Oxygen therapy	Concentrator O2	Consumables	Mask, oxygen, with connection tube, reservoir bag and valve, high-concentration, adult, non-sterile, single use	Per case		1	43	N/a
ICU	Oxygen therapy	Concentrator O2	Consumables	Mask, oxygen, with connection tube, reservoir bag and valve, high-concentration, paediatric, non-sterile, single use	Per case		1	43	N/a
ICU	Oxygen therapy	Concentrator O2	Consumables	Venturi Mask, with percent O2 Lock + 2.1 m tubing , adult	Per case		1	43	N/a
ICU	Oxygen therapy	Concentrator O2	Consumables	Venturi Mask, with percent O2 Lock + 2.1 m tubing , paediatric	Per case		1	43	N/a
ICU	Oxygen therapy	Concentrator O2	Consumables	Catheter, nasal, 8 Fr, 40 cm, with lateral eyes, sterile, single use	Per case		1	43	N/a
ICU	Oxygen therapy	Concentrator O2	Consumables	CONNECTOR, biconical, symmetric, ext. diam.7-11 mm, autoclav.	Per case		1	43	N/a
ICU	Oxygen therapy	Concentrator O2	Consumables	TUBE, silicone, autoclavable, int. diam.5 mm, 25 m	Per case		2	86	N/a
ICU	Oxygen therapy	O2 Wall	Equipment	FLOWMETER, Thorpe tube, for oxygen 0-15L/min	Per bed	2		40	N/a
ICU	Airway Management	Independent	Equipment	CRICOTHYROTOMY, SET, emergency, 6 mm, ster., s.u., w/acc.	Per centre			12	N/a
ICU	Airway Management	Independent	Consumables	AIRWAY, NASOPHARYNGEAL, sterile, set, single use (from Fr20 to Fr36)	Per case		1	43	N/a
ICU	Airway Management	Independent	Consumables	AIRWAY, OROPHARYNGEAL, Guedel, sterile, set, single use (00, 0, 1, 2, 3, 4, 5)	Per case		1	43	N/a
ICU	Airway Management	Independent	Consumables	ENDOTRACHEAL TUBE INTRODUCER, Bougie, ster., s.u., Fr15, 70cm	Per case		1	43	N/a
ICU	Airway Management	Independent	Consumables	ENDOTRACHEAL TUBE INTRODUCER, Bougie, ster., s.u., Fr10, 60cm	Per case		1	43	N/a
ICU	Airway Management	Independent	Consumables	ENDOTRACHEAL TUBE INTRODUCER, Stylet, ster., s.u., Fr14, 30 to 45 cm	Per case		1	43	N/a
ICU	Airway Management	Independent	Consumables	ENDOTRACHEAL TUBE INTRODUCER, Stylet, ster., s.u., Fr10, 30 to 45 cm	Per case		1	43	N/a
ICU	Airway Management	Independent	Consumables	TUBE, ENDOTRACHEAL, No.2, w/o cuff, ster., s.u.	Per case		1	43	N/a
ICU	Airway Management	Independent	Consumables	TUBE, ENDOTRACHEAL, No.2.5, w/o cuff, ster., s.u.	Per case		1	43	N/a
ICU	Airway Management	Independent	Consumables	TUBE, ENDOTRACHEAL, No.3, w/o cuff, ster., s.u.	Per case		1	43	N/a
ICU	Airway Management	Independent	Consumables	TUBE, ENDOTRACHEAL, No.3.5, w/o cuff, ster., s.u.	Per case		1	43	N/a
ICU	Airway Management	Independent	Consumables	TUBE, ENDOTRACHEAL, No.4, w/o cuff, ster., s.u.	Per case		1	43	N/a
ICU	Airway Management	Independent	Consumables	TUBE, ENDOTRACHEAL, No.5, w/o cuff, ster., s.u.	Per case		1	43	N/a
ICU	Airway Management	Independent	Consumables	TUBE, ENDOTRACHEAL, No.4, w/ cuff, ster., s.u.	Per case		1	43	N/a
ICU	Airway Management	Independent	Consumables	TUBE, ENDOTRACHEAL, No.5, w/ cuff, ster., s.u.	Per case		1	43	N/a
ICU	Airway Management	Independent	Consumables	TUBE, ENDOTRACHEAL, No.6, w/ cuff, ster., s.u.	Per case		1	43	N/a
ICU	Airway Management	Independent	Consumables	TUBE, ENDOTRACHEAL, No.7, w/ cuff, ster., s.u.	Per case		1	43	N/a

ICU	Airway Management	Independent	Consumables	TUBE, ENDOTRACHEAL, No.8, w/ cuff, ster., s.u.	Per case		1	43	N/a
ICU	Airway Management	Independent	Consumables	TUBE, ENDOTRACHEAL, No.9, w/ cuff, ster., s.u.	Per case		1	43	N/a
ICU	Airway Management	Independent	Consumables	LARYNGEAL MASK AIRWAY (LMA), size 2, sterile, single use	Per case		1	43	N/a
ICU	Airway Management	Independent	Consumables	LARYNGEAL MASK AIRWAY (LMA), size 3, sterile, single use	Per case		1	43	N/a
ICU	Airway Management	Independent	Consumables	LARYNGEAL MASK AIRWAY (LMA), size 4, sterile, single use	Per case		1	43	N/a
ICU	Airway Management	Independent	Consumables	COLORIMETRIC END TIDAL CO2 DETECTOR, adult, s.u.	Per case		1	43	N/a
ICU	Airway Management	Independent	Consumables	COLORIMETRIC END TIDAL CO2 DETECTOR, paediatric, s.u.	Per case		1	43	N/a
ICU	Airway Management	Independent	Consumables	SYRINGE, Luer slip, 10mL, sterile, single use	Per case		1	43	N/a
ICU	Airway Management	Independent	Consumables	LUBRICATING Jelly, 5g, box of 150	Per case		1	43	N/a
ICU	Airway Management	Independent	Consumables	FORCEPS, MAGILL, paediatric, 15 cm	Per case		1	43	N/a
ICU	Airway Management	Independent	Consumables	FORCEPS, MAGILL, child, 19 cm	Per case		1	43	N/a
ICU	Airway Management	Independent	Consumables	FORCEPS, MAGILL, adult, 24 cm	Per case		1	43	N/a
ICU	Airway Management	Laryngoscope, adult	Equipment	LARYNGOSCOPE, fib. opt, ad/ch, diam.28mm, blades (Macintosh 2/3/4 + Miller 1), sp. bulbs	Per centre			24	N/a
ICU	Airway Management	Laryngoscope, infant	Equipment	LARYNGOSCOPE, fib. opt, neonate, diam.19mm, blades (Macintosh 0/1/2), sp. bulbs, batt.	Per centre			12	N/a
ICU	Mechanical ventilation	Resuscitator, adult	Equipment	SELF-INFLATING BAG, ad./child + masks RH5 / RH2 (Ambu type)	Per centre			12	N/a
ICU	Mechanical ventilation	Resuscitator, infant	Equipment	SELF-INFLATING BAG, child/neonate + masks RH2/S1 (Ambu type)	Per centre			6	N/a
ICU	Mechanical ventilation	Suction device	Equipment	SUCTION BULB, for newborn, reusable, autoclavable	Per centre			6	N/a
ICU	Oxygen therapy	Suction Pump	Equipment	SUCTION PUMP, MECHANICAL + collection bottles	Per centre			12	N/a
ICU	Oxygen therapy	Suction Pump	Consumables	TUBE, silicone, autoclavable, int. diam.8 mm, 10 m	Per case		0,025	2,00	N/a
ICU	Mechanical ventilation	Independent	Consumables	FILTER, HEAT AND MOISTURE EXCHANGER (HMEF), high efficiency, with connectors, adult, single use	Per case		0,8	35	N/a
ICU	Mechanical ventilation	Independent	Consumables	FILTER, HEAT AND MOISTURE EXCHANGER (HMEF), high efficiency, with connectors, paediatric, single use	Per case		0,2	9	N/a
ICU	Gastro-enteral Feeding	Independent	Consumables	TUBE, FEEDING, NASOGASTRIC, 10 Fr, 50 cm, ENFit tip, sterile, single use	Per case		1	43	N/a
ICU	Gastro-enteral Feeding	Independent	Consumables	TUBE, FEEDING, NASOGASTRIC, 12 Fr, 90 cm, ENFit tip, sterile, single use	Per case		1	43	N/a
ICU	Gastro-enteral Feeding	Independent	Consumables	TUBE, FEEDING, NASOGASTRIC, 14 Fr, 90 cm, ENFit tip, sterile, single use	Per case		1	43	N/a

ICU	Gastro- enteral Feeding	Independen t	Consumables	TUBE, FEEDING, NASOGASTRIC, 6 Fr, 50 cm, ENFit tip, sterile, single use	Per case		1	43	N/a
ICU	Gastro- enteral Feeding	Independen t	Consumables	TUBE, FEEDING, NASOGASTRIC, 8 Fr, 50 cm, ENFit tip, sterile, single use	Per case		1	43	N/a
ICU	Gastro- enteral Feeding	Independen t	Consumables	SYRINGE, FEEDING, 1 mL, LDT, ENFit, sterile, single use	Per case		1	43	N/a
ICU	Gastro- enteral Feeding	Independen t	Consumables	SYRINGE, FEEDING, 10 mL, ENFit, sterile, single use	Per case		1	43	N/a
ICU	Gastro- enteral Feeding	Independen t	Consumables	SYRINGE, FEEDING, 2.5 mL, LDT, ENFit, sterile, single use	Per case		1	43	N/a
ICU	Gastro- enteral Feeding	Independen t	Consumables	SYRINGE, FEEDING, 20 mL, ENFit, sterile, single use	Per case		1	43	N/a
ICU	Gastro- enteral Feeding	Independen t	Consumables	SYRINGE, FEEDING, 5 mL, LDT, ENFit, sterile, single use	Per case		1	43	N/a
ICU	Gastro- enteral Feeding	Independen t	Consumables	SYRINGE, FEEDING, 60 mL, ENFit, sterile, single use	Per case		1	43	N/a
ICU	Gastro- enteral Feeding	Independen t	Consumables	LUBRICATING Jelly, 50g, tube	Per bed	1		20	N/a
ICU	Gastro- enteral Feeding	Independen t	Consumables	PAD, absorbent	Per case		1	43	N/a
ICU	Gastro- enteral Feeding	Independen t	Consumables	BASIN KIDNEY, stainless steel, 825 mL	Per bed	1		20	N/a
ICU	Gastro- enteral Feeding	Independen t	Consumables	STETHOSCOPE, binaural, double cup, adult/child, single use	Per bed	1		20	N/a
ICU	Central line	Independen t	Consumables	CENTRAL VENOUS CATHETERS KIT	Per case		1	43	N/a
ICU	Central line	Independen t	Consumables	Transparent adhesive plasters, washproof, 5x5 cm	Per case		3	129	N/a
ICU	Urine collection	Independen t	Consumables	Bag, collecting, urine, with outlet tap, with non-return valve, 2000 mL, adult, non-sterile, single use	Per case		1	43	N/a
ICU	Urine collection	Independen t	Consumables	CATHETER, URETHRAL, Foley, 2- way, 10 Fr, sterile, single use	Per case		1	43	N/a
ICU	Urine collection	Independen t	Consumables	CATHETER, URETHRAL, Foley, 2- way, 12 Fr, sterile, single use	Per case		1	43	N/a
ICU	Urine collection	Independen t	Consumables	CATHETER, URETHRAL, Foley, 2- way, 14 Fr, sterile, single use	Per case		1	43	N/a
ICU	Urine collection	Independen t	Consumables	CATHETER, URETHRAL, Foley, 2- way, 16 Fr, sterile, single use	Per case		1	43	N/a
ICU	Urine collection	Independen t	Consumables	CATHETER, URETHRAL, Foley, 2- way, 18 Fr, sterile, single use	Per case		1	43	N/a
ICU	Urine collection	Independen t	Consumables	CATHETER, URETHRAL, Foley, 2- way, 20 Fr, sterile, single use	Per case		1	43	N/a
ICU	Urine collection	Independen t	Consumables	CATHETER, URETHRAL, Foley, 2- way, 8 Fr, sterile, single use	Per case		1	43	N/a
ICU	General supplies	Independen t	Consumables	Compress, gauze, 10 x 10 cm, 8 to 12 ply, sterile, single use	Per case		1	43	N/a
ICU	General supplies	Independen t	Consumables	Tape, surgical, hypoallergenic, 5 x 2.5 cm	Per case		1	43	N/a
ICU	General supplies	Independen t	Consumables	Drape, surgical, non woven, sterile, single use	Per case		1	43	N/a
ICU	General supplies	Independen t	Consumables	Gloves, examination, nitrile, powder-free, pair-packed, large, sterile, single use	Per case		1	43	N/a
ICU	General supplies	Independen t	Consumables	Gloves, examination, nitrile, powder-free, pair-packed, medium, sterile, single use	Per case		1	43	N/a
ICU	General supplies	Independen t	Consumables	Gloves, examination, nitrile, powder-free, pair-packed, small, sterile, single use	Per case		1	43	N/a

ICU	General supplies	Independent	Consumables	Antiseptic Wipe with Alcohol & Chlorhexidine	Per case		1	43	N/a
ICU	Blood Chemistry	Independent	Consumables	Arterial Blood Sample Kits	Per case		1	43	N/a
ICU	Mechanical ventilation	Patient Ventilator	Equipment	VENTILATOR PATIENT, for adult, paediatric and neonate w/acc.	Per bed	0,5		10	N/a
ICU	Mechanical ventilation	Patient Ventilator	Consumables	Breathing circuit (tubes/balloon/valves/mask), ADULT, single use	Per case		0,8	35	N/a
ICU	Mechanical ventilation	Patient Ventilator	Consumables	Breathing circuit (tubes/balloon/valves/mask), PAEDIATRIC, single use	Per case		0,15	7	N/a
ICU	Mechanical ventilation	Patient Ventilator	Consumables	Breathing circuit (tubes/balloon/valves/mask), NEONATE, single use	Per case		0,05	3	N/a
ICU	Oxygen therapy	HFNC	Equipment	High Flow Nasal Cannula (HFNC)	Per bed	0,5		10	N/a
ICU	Oxygen therapy	HFNC	Consumables	Optiflow + Nasal Cannula, small, pack of 20	Per case		1	43	N/a
ICU	Oxygen therapy	HFNC	Consumables	Optiflow + Nasal Cannula, medium, pack of 20	Per case		1	43	N/a
ICU	Oxygen therapy	HFNC	Consumables	Optiflow + Nasal Cannula, large, pack of 20	Per case		1	43	N/a
ICU	Oxygen therapy	HFNC	Consumables	Disinfection kit	Per case		0,8	35	N/a
ICU	Oxygen therapy	HFNC	Consumables	Cleaning Sponge Stick, pack of 20	Per case		0,15	7	N/a
ICU	Oxygen therapy	HFNC	Consumables	Disinfection filter, pack of 2	Per case		0,05	3	N/a
ICU	Oxygen therapy	Suction Pump	Equipment	SUCTION PUMP, ELECTRICAL, 100-230V,50-60Hz	Per bed	1		20	N/a
ICU	Oxygen therapy	Suction Pump	Consumables	BACTERIA FILTER, unit	Per case		0,5	22	N/a
ICU	Oxygen therapy	Suction Pump	Consumables	TUBE, silicone, autoclavable, int. diam.8 mm, 10 m	Per case		1	43	N/a
ICU	Drug administration	Infusion Pump	Equipment	INFUSION PUMP	Per bed	1		20	N/a
ICU	Drug administration	Infusion Pump	Consumables	(inf. pump) INFUSION LINE	Per case		2	86	N/a
ICU	Drug administration	Drill	Equipment	DRILL, FOR VASCULAR ACCESS, with transport bag	Per centre			3	N/a
ICU	Drug administration	Drill	Consumables	NEEDLE + STABILIZER KIT, 15 G, 15 mm, PAEDIATRIC	Per case		0,1	5	N/a
ICU	Drug administration	Drill	Consumables	NEEDLE + STABILIZER KIT, 15 G, 25 mm, ADULT	Per case		0,08	4	N/a
ICU	Monitoring	Defibrillator	Equipment	DEFIBRILLATOR, mobile, semi-auto.,multi-paramet,AC/DC, w/acc+trolley	Per centre			3	N/a
ICU	Monitoring	Defibrillator	Consumables	(defibrillator) ELECTRODE PADS, adult, adhesive, disp.	Per case		0,08	4	N/a
ICU	Monitoring	Defibrillator	Consumables	(defibrillator) ELECTRODE PADS, paediat., adhesive, disp.	Per case		0,02	1	N/a
ICU	Monitoring	ECG	Equipment	ELECTROCARDIOGRAPH, portable, 3 ch+ACC	Per centre			3	N/a
ICU	Monitoring	ECG	Consumables	(ECG) RECORDING PAPER, pack	Per Bed-Day			6	N/a
ICU	Monitoring	ECG	Consumables	(ECG) ELECTRODE GEL, bottle	Per case		0,01	1	N/a
ICU	Diagnostic imaging	Ultrasound	Equipment	ULTRASOUND, SYSTEM, MOBILE, transducer, trolley, 220V, w/ acc.	Per centre			3	N/a
ICU	Diagnostic imaging	Ultrasound	Consumables	(ultrasound transducer) CONDUCTIVE GEL, 5L, container	Per case		0,01	1	N/a
ICU	Blood Chemistry	Chemistry Analyser	Equipment	CLINICAL CHEMISTRY ANALYSER	Per centre			3	N/a
ICU	Blood Chemistry	Chemistry Analyser	Consumables	CARTRIDGE for Chemistry analyser (lactic acidosis and hyperlactatemia)	Per case		2	86	N/a

ICU	Blood Chemistry	Chemistry Analyser	Consumables	CARTRIDGE (metabolic status and renal function)	Per case		1	43	N/a
ICU	Blood Chemistry	Chemistry Analyser	Consumables	CONTROL,solution 1	Per equipment			6	N/a
ICU	Blood Chemistry	Chemistry Analyser	Consumables	CONTROL,solution 2	Per equipment			6	N/a
ICU	Blood Chemistry	Chemistry Analyser	Consumables	CONTROL,solution 3	Per equipment			6	N/a
ICU	Blood Chemistry	Chemistry Analyser	Consumables	TUBE, VACUUM, plastic, Li-HEPARIN, 2 mL green	Per case		2	86	N/a
ICU	Blood Chemistry	Chemistry Analyser	Consumables	TUBE, VACUUM, plastic, Li-HEPARIN, 4 mL green	Per case		2	86	N/a
ICU	Monitoring	Table, neonate	Equipment	Table, resuscitation, neonate	Per centre			6	N/a
Ancillary	Drug administration	Scale, infant	Equipment	INFANT SCALE, electronic, 0-20 kg	Per centre			6	N/a
Ancillary	Drug administration	Scale, adult	Equipment	SCALE, electronic, 50g/0-200kg	Per centre			6	N/a
Ancillary	Sterilization	Autoclave, 39 L	Equipment	AUTOCLAVE, 39 L, with single burner	Per centre			3	N/a
Ancillary	Sterilization	Autoclave, 39 L	Consumables	Indicator, TST (Time, Steam, Temperature), Type 5	Per Bed-Day			300	N/a
Ancillary	Sterilization	Autoclave, 39 L	Consumables	Paper sheet, crepe, for sterilization, 60 g/m2, 90 x 90 cm	Per Bed-Day			300	N/a
Ancillary	Sterilization	Autoclave, 39 L	Consumables	Paper sheet, non-woven, for sterilization, 120 x 120 cm	Per Bed-Day			300	N/a
Ancillary	Sterilization	Autoclave, 39 L	Consumables	Tape, adhesive, indicator Type 1, for steam sterilizer, 18 mm x 48 m	Per Bed-Day			300	N/a
Ancillary	Sterilization	Autoclave, 39 L	Equipment	Kerosene stove, electric heating plate	Per centre			3	N/a
Ancillary	Sterilization	Autoclave, 39 L	Equipment	Timer	Per centre			3	N/a

Medical Drugs

Source: **ECOVID-19 100 PATIENT KIT - MODULE DRUGS & Med Supplies_050320_2**

KIT COVID-19 - 100 patients/20 severe MODULE DRUGS, general cargo		
WHO Code	WHO Description	Total Qty
PINJADEN6A---A1	ADENOSINE, 3 mg/ml, 2 ml, amp.	15
PEXTALCO1G---A1	ALCOHOL-BASED HAND RUB, gel, 100mL, bottle	100
PEXTALCO5S---A1	ALCOHOL-BASED HAND RUB, solution, 500mL, bottle	50
PINJAMIO1A---A1	AMIODARONE hydrochloride, 50 mg/ml, 3 ml, amp.	15
PORLAMOC15S1-A1	AMOXICILLIN 125mg/CLAVULANIC ac.31.25mg, eq.156.25mg/5mL, oral susp., 100mL bot.	50
PORLAMOC5T1--A1	AMOXICILLIN 500 mg / CLAVULANIC acid 125 mg, eq. 625mg/tab, tablet	200
PORLAMOX2T---A1	AMOXICILLIN, 250 mg, tab.	200
PORLAMOX5T---A1	AMOXICILLIN, 500 mg, tab.	1000
PINJAMPI1V---A1	AMPICILLIN, 1g, powder, vial	250
PINJAMPI5V---A1	AMPICILLIN, 500 mg, powder, vial	100
PORLASCA2T---A1	ASCORBIC acid (vitamin C), 250 mg, tab.	200
PORLATEN5T---A1	ATENOLOL, 50 mg, tab.	100
PINJATRO1A---A1	ATROPINE sulfate, 1 mg/mL, 1 mL, ampoule	20
PORLAZIT2S---A1	AZITHROMYCIN, 200mg/5ml, powder oral susp., 15mL, bottle	50
PORLAZIT2T---A1	AZITHROMYCIN, 250mg, tab.	100

PORLAZIT5T---A1	AZITHROMYCIN, 500mg, tab	200
PINJPENB5V---A1	BENZYL PENICILLIN, 5MIU (3g), powder, vial	100
PINJCALG1A1--A1	CALCIUM GLUCONATE, 100 mg/mL, 10mL, ampoule	25
PINJCEFT25V--A1	CEFTRIAXONE sodium, 250mg, powder, vial	200
PINJCEFT1V---A1	CEFTRIAXONE sodium, eq. 1 g base, powder for inject., vial	500
PORLCHLA5T---A1	CHLORAL HYDRATE, 500mg, tab.	250
PEXTCHLH1C15SA1	CHLORHEXIDINE digluconate 1.5% + CETRIMIDE 15%, solution, 1000ml, bottle	50
PORLCHLM2T---A1	CHLORPROMAZINE hydrochloride, eq.25mg base, tab.	100
PINJCLOX5V---A1	CLOXACILLIN sodium salt, 500mg, powder, vial	300
PORLCLOX2C---A1	CLOXACILLIN sodium, eq.250mg base, caps.	100
PINJDEXA4A---A1	DEXAMETHASONE phosphate, 4mg/ml, 1ml, ampoule	200
PINJDEXM1A2--A1	DEXMEDETOMIDINE, 100mcg/mL, IV, 2mL amp.	30
PINFDEXT5N1--A1	DEXTROSE (GLUCOSE) 5%, 1L, plastic pouch	50
PINFDEXT5N5--A1	DEXTROSE (GLUCOSE) 5%, 500mL, plastic pouch	20
PORLDOXY1T---A1	DOXYCYCLINE salt, 100mg, tab.	300
PINJEPIN1AV--A1	EPINEPHRINE (adrenaline) tartrate, eq.1mg/mL base, 1mL amp. IV	100
PINJFLUM1A5--A1	FLUMAZENIL, 0.1mg/mL, IV, 5mL amp.	15
PINJFURO1A---A1	FUROSEMIDE, 10mg/mL, 2mL, ampoule	100
PORLFURO4T---A1	FUROSEMIDE, 40 mg, tab.	100
PINJGLUC5V5--A1	GLUCOSE hypertonic, 50%, 50mL, vial	20
PORLGLYT3T---A1	GLYCERYL TRINITRATE, 0.3mg, sublingual tab.	100
PINJGLYT5A1--A1	GLYCERYL TRINITRATE, 5mg/mL, for infusion, 10mL amp.	15
PINJHYDA2A---A1	HYDRALAZINE hydrochloride, 20mg, powder, ampoule	40
PORLHYDO5T---A1	HYDROCHLOROTHIAZIDE, 50 mg, tab.	100
PINJHYDR1V---A1	HYDROCORTISONE sodium succinate, eq.100mg base, powder, vial	100
PORLBUP4T---A1	IBUPROFEN, 400 mg, tab.	200
PINJLIDO1V2--A1	LIDOCAINE hydrochloride, 1%, for inject., 20mL, vial	100
PINJMAGS5A1--A1	MAGNESIUM sulfate, 500mg/mL, 10mL, ampoule	40
PINJMETO5A---A1	METOCLOPRAMIDE hydrochloride, 5mg/mL, 2mL, amp.	500
PINJMPRO1A---A1	METOPROLOL tartrate, 1mg/ml, IV injection, 5ml, amp.	15
PINJMETN5SR1-A1	METRONIDAZOLE, 5mg/mL, 100 ml, semi-rigid bot.	100
PORLMULT1T---A1	MULTIVITAMINS, tab.	200
PINJNALO4A1--A1	NALOXONE hydrochloride, 0.4mg/mL, 1 mL, ampoule	50
PINJNORA1AV4-A1	NORADRENALINE tartrate, sol.for infu., eq.1mg/mL base, 4mL, amp/vial	200
PORLNYST1S---A1	NYSTATIN, 100.000 IU/ml, oral susp.	50
PORLOMEP2CG--A1	OMEPRAZOLE, 20 mg, gastro-resistant, caps.	100
PINJOME4V---A1	OMEPRAZOLE, 40mg, powder, vial	100
PINJONDA2A---A1	ONDANSETRON hydrochloride, 2mg/ml, 2ml, amp.	50
PORLONDA4A---A1	ONDANSETRON hydrochloride, 4mg, tab.	200
PORLORSA2S---A1	ORAL REHYDRATION SALTS (ORS) low osmol., sachet 20.5 g/1l	100
PORLPARA1T---A1	PARACETAMOL (acetaminophen), 100mg, tab.	300
PINJPARA1B5--A1	PARACETAMOL (acetaminophen), 10mg/mL, inject, 50mL, bot.	20
PINJPARA111N-A1	PARACETAMOL (acetaminophen), 10mg/ml, inject., 100 ml, plastic pouch	80
PORLPARA1S10-A1	PARACETAMOL (acetaminophen), 120 mg/5 ml, syrup, 100 ml, bottle	80
PORLPARA5T---A1	PARACETAMOL (acetaminophen), 500 mg, tab.	2000
PORLPHEY10T--A1	PHENYTOIN sodium, 100mg, coated tab.	450
PINJPHEY5V5--A1	PHENYTOIN sodium, 50mg/mL, 5mL, vial	100
PINJPOTC1A---A1	POTASSIUM chloride, 100mg/mL, 10 mL, amp.	100
PORLPRED5T---A1	PREDNISOLONE, 5 mg, tab.	1000
PORLRANI1T---A1	RANITIDINE, 150mg, tab.	75
PINFRINL1N1--A1	RINGER lactate, 1L, plastic pouch	400

PINFRINL1N5--A1	RINGER lactate, 500mL, plastic pouch	50
PORLSALB2S---A1	SALBUTAMOL sulfate, eq.0.1mg base/puff, 200 puffs, inhaler	100
PINJSODB8A2--A1	SODIUM BICARBONATE, 8.4%, 1 mEq/mL, 20mL amp.	10
PINFSDOC9N1--A1	SODIUM chloride, 0.9%, 1L, plastic pouch	100
PINFSDOC9N5--A1	SODIUM chloride, 0.9%, 500 ml, plastic pouch	25
PORLSULF4T8T-A1	SULFAMETHOXAZOLE 400mg/TRIMETHOPRIM 80mg, tab.	200
PORLTHIA5T---A1	THIAMINE hydrochloride (vitamin B1), 50mg, tab.	100
PINJWATE1A1--A1	WATER for injection, 10 mL, ampoule	4000
PORLYINS2T---A1	ZINC sulfate, eq. to 20 mg zinc mineral, dispersible tab.	100
	Saline ampoules, 10 cc	
	Linezoli IV	
	Heparin LMW	
	Lacilube	

KIT COVID-19 - 100 patients / 20 severe MODULE DRUGS, cold chain

WHO Code	WHO Description	Total Qty
PINJATRB1A5--A1	ATRACURIUM BESILATE, 10mg/mL, 5mL, amp. INSULIN RAPID (Actrapid), rDNA insul.,100 IU/mL, 10mL, vial SUXAMETHONIUM CHLORIDE, 50mg/mL, 2mL, amp.ADENOSINE, 3 mg/ml, 2 ml, amp.	45
PINJINSH1V1R-A1	ALCOHOL-BASED HAND RUB, gel, 100mL, bottle	25
PINJSUXA5A2--A1	ALCOHOL-BASED HAND RUB, solution, 500mL, bottle	45

KIT COVID-19 - 100 patients/20 severe MODULE DRUGS, controlled drugs

WHO Code	WHO Description	
PORLDIAZ5T---A1	DIAZEPAM, 5mg, tab.	100
PINJDIAZ5A2--A1	DIAZEPAM, 5mg/ml, 2ml, amp.	100
PINJFENT1A---A1	FENTANYL citrate, eq. 0.05mg/mL base, 2 mL, amp.	50
PINJFENT5A---A1	FENTANYL, 0.05mg/mL, 10mL, amp.	50
PINJHALP5A1--A1	HALOPERIDOL, 5mg/mL, sol. for inject., 1mL, ampoule	200
PINJKETA5V---A1	KETAMINE hydrochloride, eq. 50 mg/mL base, 10 mL, vial	50
PINJMIDA5A3--A1	MIDAZOLAM, 5mg/ml, 3ml, amp.	50
PINJMORP10A1-A1	MORPHINE sulfate, 10mg/ml, 1ml, amp.	100
PINJPHEN20A1-A1	PHENOBARBITAL (sodium), 200mg/mL, 1mL, amp.	100
PORLPHEN5T---A1	PHENOBARBITAL, 50mg, tab.	100
PINJPROP1A---A1	PROPOFOL, 10mg/mL, 10mL, amp.	100

KIT COVID-19 - 100 patients/20 severe SUPPLIES FOR MEDICINE ADMINISTRATION

Medical purpose	WHO Code	WHO Description	Total Qty
Injection, Intravenous , Infusion		Gloves, examination, nitrile, powder-free, large, non-sterile, single use	300
Injection, Intravenous , Infusion		Gloves, examination, nitrile, powder-free, medium, non-sterile, single use	200
Injection, Intravenous , Infusion		Gloves, examination, nitrile, powder-free, small, non-sterile, single use	100
Injection, Intravenous , Infusion	CINSSETI2----A1	SET, INFUSION 'Y', Luer lock, air inlet, sterile, s.u.	2.000
Injection, Intravenous , Infusion		Infusion giving set, with air intake, with injection port, with burette, sterile, single use	200
Injection, Intravenous , Infusion	CINSIVCRW16--A1	IV CATHETER, retractable, 16G (1.7 x 45mm), wings, grey	200
Injection, Intravenous , Infusion	CINSIVCRW18--A1	IV CATHETER, retractable, 18G (1.2 x 45mm), wings, green	200
Injection, Intravenous , Infusion	CINSIVCRW20--A1	IV CATHETER, retractable, 20G (1.0 x 32mm), wings, pink	200
Injection, Intravenous , Infusion	CINSIVCRW22--A1	IV CATHETER, retractable, 22G (0.8 x 25mm), wings, blue	200
Injection, Intravenous , Infusion	CINSIVCRW24--A1	IV CATHETER, retractable, 24G (0.7 x 19mm), wings, yellow	200
Injection, Intravenous , Infusion	CINSSCAV21---A1	SCALP VEIN, butterfly needle, 21G (0.8x19mm), s.u, ster., green	200
Injection, Intravenous , Infusion	CINSSCAV23---A1	SCALP VEIN, butterfly needle, 23 G (0.6x19 mm), s.u., ster., blue	200
Injection, Intravenous , Infusion	CINSSCAV25---A1	SCALP VEIN, butterfly needle, 25G (0.5x19mm), s.u., ster., orange	200
Injection, Intravenous , Infusion	CINSEXTS3----A1	Stopcock, 3-way, for infusion giving set, with connection line, sterile, single use	200
Injection, Intravenous , Infusion		Stopper / closing cone, for IV sets, with male and female Luer lock, sterile, single use	2.000
Injection, Intravenous , Infusion	CINSNEED18H1-A1	NEEDLE, hypodermic, Luer, 18G, ster., s.u., pink	200
Injection, Intravenous , Infusion	CINSNEED19H1-A1	NEEDLE, hypodermic, Luer, 19Gx1.5" (1.1x40mm), ster., s.u., cream	200
Injection, Intravenous , Infusion	CINSNEED21H1-A1	NEEDLE, hypodermic, Luer, 21Gx1.5" (0.8x40mm), ster., s.u., green	300
Injection, Intravenous , Infusion	CINSNEED22H1-A1	NEEDLE, hypodermic, Luer, 22G, ster., s.u., black	200
Injection, Intravenous , Infusion	CINSNEED23H1-A1	NEEDLE, hypodermic, Luer, 23Gx1"(0.6x25mm), ster., s.u., blue	200
Injection, Intravenous , Infusion	CINSSYDL20---A1	SYRINGE, Luer, 20mL, ster., s.u.	100

Injection, Intravenous, Infusion	CINSSYDL05---A1	SYRINGE, Luer, 5mL, ster., s.u.	1.000
Injection, Intravenous, Infusion	CINSSYDL02---A1	SYRINGE, Luer, 2mL, ster., s.u.	1.000
Injection, Intravenous, Infusion	CINSSYDL10---A1	SYRINGE, Luer, 10mL, ster., s.u.	200
Injection, Intravenous, Infusion	YMEQTOURR01--A1	TOURNIQUET, elastic, rubber, latex free, s.u., 100 x 1.8 cm	20
Injection, Intravenous, Infusion	CINSCONTC51--A1	SAFETY BOX, needles/syringes, 5l, cardboard for incineration	20
Injection, Intravenous, Infusion		Adhesive plasters, washproof, spot shape or 2x1.3 cm	2.500
Injection, Intravenous, Infusion		IODINE POVIDONE, 10%, solution, 1L, btl.	8
Injection, Intravenous, Infusion	CDRECOTW5R--A1	COTTON WOOL, hydrophillic, 500 g, roll	20
Injection, Intravenous, Infusion		COMPRESS, GAUZE, 10 x 10 cm, 8 plys, 17 thr., ster., 2 pcs	1.000
Injection, Intravenous, Infusion		COMPRESS, GAUZE, 10 x 20 cm, 12 plys, 17 threads, non-ster.	1.000
Injection, Intravenous, Infusion		FORCEPS, DRESSING, BLANK, 14.5 cm, atraumatic serration	4
Injection, Intravenous, Infusion		BOWL, ROUND, 100 ml, 80 x 35 mm, stainless steel	4
Injection, Intravenous, Infusion	CDRETAPZO2---A1	ZINC OXIDE, TAPE, self-adhesive, 2.5 cm x 5 m, white, roll	50
Injection, Intravenous, Infusion		Spacer, for metered dose inhaler	20

Annex 3 Calculations

Source: EMT Technical consultants assumptions based on Standards

WATER SUPPLY

Water quantity Calculations

A) L Model (100m x 80m) 160 Moderate inpatients + 20 ICU beds + 60 staff around 20.000 litres per day

Water demand estimate							
<u>WATER QUANTITY</u>							
_There is enough water to drink, to prepare food, "to perform personal grooming and medical activities, cleaning and laundry at all times."							
		Patients/person/toilets	Unit	Quantity according to standard (litre/piece/day)	Standard	Needed water supply per day	
DRINKING	Running Water	180	Inpatient	60	Sphere/WHO	10.800	
		60	EMT Staff	40	Sphere/WHO	2.400	
OTHER USES	Flush Toilets	400	Uses	5	Sphere	2.000	

	Cleaning Floors	8000	Total m2 installations	0,2	---	1.600	
	Cleaning Inpatient	180	Inpatients beds	20		3.600	
	Cleaning Toilets	14	Toilets	20	Sphere	280	
						20.680	litres /day

B) XL Model (180m x 100m) 480 Moderate inpatients + 20 ICU beds + 140 staff

Water demand estimate							
<u>WATER QUANTITY</u>							
_There is enough water to drink, to prepare food, "to perform personal grooming and medical activities, cleaning and laundry at all times."							
		Patients/person/toilets	Unit	Quantity according to standard (litre/piece/day)	Standard	Needed water supply per day	
DRINKING	Running Water	500	Inpatient	60	Sphere/WHO	30.000	
		140	EMT Staff	40	Sphere/WHO	5.600	
OTHER USES	Flush Toilets	1200	Uses	5	Sphere	6.000	
	Cleaning Floors	18000	Total m2 installations	0,2	---	3.600	
	Cleaning Inpatient	500	Inpatients beds	20		10.000	
	Cleaning Toilets	50	Toilets	20	Sphere	1.000	
						56.200	litres /day

Water Storage Capacity Calculations

Storage capacity: If there is a continuous water supply would be convenient to store a certain amount of water for contingency purposes

A) L Model (100m x 80m) 160 Moderate inpatients + 20 ICU beds + 60 staff . 40.000 litres

<u>WATER STORAGE</u>				
_There is enough water storage capacity for 48 hours supply				
Total Water storage capacity required	39.440 litres /day	Number of STORAGE TANKS 1000 litres	40	uds
or				
		Number of STORAGE TANKS 2000 litres	20	uds
or				
		Number of STORAGE TANKS 5000 litres	8	uds

B) XL Model (180m x 100m) 480 Moderate inpatients + 20 ICU beds + 140 staff

Storage capacity: If there is a continuous water supply would be convenient to store a certain amount of water for contingency purposes

WATER STORAGE				
There is enough water storage capacity for 48 hours supply				
Total Water storage capacity required	112.400 litres /day	Number of STORAGE TANKS 5000 litres	23	uds
or				
		Number of STORAGE TANKS 10.000 litres	12	uds
or				
		Number of STORAGE TANKS 20.000 litres	6	uds

Water distribution network calculations

A) L Model (100m x 80m) 160 Moderate inpatients + 20 ICU beds + 60 staff

Model L	Quantity	units
Total pipe length	511,95	metres
Total Tee 25 mm	32	units
Total Elbow	4	units
Total Gate valves	45	units
Total Water supply points connexions	24	Connexions

B) XL Model (180m x 100m) 480 Moderate inpatients + 20 ICU beds + 140 staff

Model XL	Quantity	units
Total pipe length	1138,59	metres
Total Tee 25 mm	64	units
Total Elbow	12	units
Total Gate valves	88	units
Total Water supply points connexion	48	Connexions

WASTE MANAGEMENT

Waste generation calculations

A) L Model (100m x 80m) 160 Moderate inpatients + 20 ICU beds + 60 staff

Generation Health care waste management TST					
Healthcare waste disposal Healthcare waste is separated, collected, transported, treated and disposed of safely.					
Patients/Beds	Unit	Quantity Waste according to average (kg/ bed/day)	Standard	Comments	kg/ day
180	Patients	2	WHO	GENERAL WASTE 2 kg/ patient /day	360
180	Patients	0,1		SHARPS 0.1 kg/ patient/day	18
180	Patients	0,4		INFECTIOUS WASTE 0.4 kg/ patient /day	72
					450 Kg/day

B) XL Model (180m x 100m) 480 Moderate inpatients + 20 ICU beds + 140 staff

Generation Health care waste management TST					
Healthcare waste disposal Healthcare waste is separated, collected, transported, treated and disposed of safely.					
Patients/Beds	Unit	Quantity Waste according to average (kg/ bed/day)	Standard	Comments	kg/ day
500	Patients	2	WHO	GENERAL WASTE 2 kg/ patient /day	1000
500	Patients	0,1		SHARPS 0.1 kg/ patient/day	50
500	Patients	0,4		INFECTIOUS WASTE 0.4 kg/ patient /day	200
					1250 Kg/day

Waste containment calculations

A) L Model (100m x 80m) 160 Moderate inpatients + 20 ICU

Containment needs for infectious waste			
Assumptions: maximum storage of infectious waste should be max. 2 days // The average density of the uncompacted waste is 200 kg/m ³ or 1000 litres / 200 kg			
	Volume Waste/day (m ³)	Containment capacity for 2 days (m ³)	Containment capacity for 2 days (litres)
INFECTIOUS WASTE	0,36	0,72	720

B) XL Model (180m x 100m) 480 Moderate inpatients + 20 ICU beds

Containment needs for infectious waste			
Assumptions: maximum storage of infectious waste should be max. 2 days // The average density of the uncompacted waste is 200 kg/m ³ or 1000 litres / 200 kg			
	Volume Waste/day (m ³)	Containment capacity for 2 days (m ³)	Containment capacity for 2 days (litres)
INFECTIOUS WASTE	1	2	2000

Waste treatment technology capacity calculations

A) L Model (100m x 80m) 160 Moderate inpatients + 20 ICU

Treatment capacity needed for infectious waste			
Assumptions: 10 working hours			
	weight (Kg/day)	Working hours Treatment technology (hours)	Treatment capacity per hour needed (kg/hour)
INFECTIOUS WASTE	72	10	8

B) XL Model (180m x 100m) 480 Moderate inpatients + 20 ICU beds

Treatment capacity needed for infectious waste			
Assumptions: 10 working hours			
	weight (Kg/day)	Working hours Treatment technology (hours)	Treatment capacity per hour needed (kg/hour)
INFECTIOUS WASTE	72	10	8

SANITATION

Sanitation facilities calculations

A) L Model (100m x 80m) 160 Moderate inpatients + 20 ICU beds + 60 staff

Estimating the demand for sanitation facilities TST							
Adequate, accessible and culturally appropriate toilets and showers are available to patients, staff and caregivers							
AREA	Facility	Patients/persons/units	Unit	Quantity according to standard ratio persons per facility	Standard	Comments	Latrines/Bathrooms needed
TRIAGE / RECEPTION	WC	1	Area	1		Gender factor x 2	2
	Basin	2	Area	1			2
2 MODULE 80 pex	WC	80	Inpatient	20			8
	Shower	80	Inpatient	40		we assume 20 pex as more confort	8

	Basin	2	Area	1			4
MODULE ICU 20 pex	WC	20	Inpatient	20		Gender factor x 2	2
	Shower	20	Inpatient	40		we assume 20 pex as more comfort + Gender factor x 2	2
	Basin	1	Area	1			1
TECHNICAL AERA	WC	4	Inpatient	1		Gender factor x 2	4
	Shower	4	Inpatient	1		we assume 20 pex as more comfort + Gender factor x 2	4
	Basin	4	Area	1		Waste management	4

B) XL Model (180m x 100m) 480 Moderate inpatients + 20 ICU beds

Estimating the demand for sanitation facilities TST							
Adequate, accessible and culturally appropriate toilets and showers are available to patients, staff and caregivers							
AREA	Facility	Patients/persons/units	Unit	Quantity according to standard ratio persons per facility	Standard	Comments	Latrines/Bathrooms needed
TRIAGE / RECEPTION	WC	1	Area	1		Gender factor x 2	2
	Basin	2	Area	1			2
6 MODULE 80 pex	WC	80	Inpatient	20			24
	Shower	80	Inpatient	40		we assume 20 pex as more comfort	24
	Basin	2	Area	1			12
MODULE ICU 20 pex	WC	20	Inpatient	20		Gender factor x 2	2
	Shower	20	Inpatient	40		we assume 20 pex as more comfort + Gender factor x 2	2
	Basin	1	Area	1			1
TECHNICAL AERA	WC	4	Inpatient	1		Gender factor x 2	4
	Shower	4	Inpatient	1		we assume 20 pex as more comfort + Gender factor x 2	4
	Basin	4	Area	1		Waste management	4

Annex 4 Analysis tool COVID19 community facilities and Treatment Centers Construction

CONTEXT

- To get information of the characteristics of pre-existing health infrastructures
- To choose a location with a proper characteristic.
- Good access and communications
- To guarantee proper access to the infrastructures
- To know the physical characteristics of the environment
- To get information about the socio-cultural characteristics of the place

AREAS OF ANALYSIS

1. Functional-Spatial Analysis

AREA 1	AREA 2 Technical area	AREA 3 Wards
--------	--------------------------	-----------------

Triage /Admission and registration Area		
<input type="checkbox"/> Entry <input type="checkbox"/> Reception <input type="checkbox"/> Waiting room <input type="checkbox"/> Crash room <input type="checkbox"/> Triage <input type="checkbox"/> Sample area <input type="checkbox"/> Admission <input type="checkbox"/> Waiting results room <input type="checkbox"/> Exit <input type="checkbox"/> Bathrooms	<p>Clinical</p> <input type="checkbox"/> Entry for staff <input type="checkbox"/> Office <input type="checkbox"/> Personal access <input type="checkbox"/> Changing room <input type="checkbox"/> Store PPE <input type="checkbox"/> Changing rooms male/female <input type="checkbox"/> Storage scrubs <input type="checkbox"/> Bathrooms <input type="checkbox"/> Rest leisure staff <input type="checkbox"/> Coordination area <input type="checkbox"/> Meeting point <input type="checkbox"/> Laboratory <input type="checkbox"/> Pharmacy <input type="checkbox"/> Donning room	<p>Inpatient area (Module of 40 beds)</p> <input type="checkbox"/> Entrance <input type="checkbox"/> Wards <input type="checkbox"/> Water modules <input type="checkbox"/> Storage modules <input type="checkbox"/> Rest area for patients <input type="checkbox"/> Exit not admitted patients <input type="checkbox"/> Exit staff with PPE <input type="checkbox"/> Doffing area <input type="checkbox"/> Bathrooms
	<p>Operational support</p> <input type="checkbox"/> Technical room <input type="checkbox"/> Water supply <input type="checkbox"/> Equipment warehouse <input type="checkbox"/> Electricity area <input type="checkbox"/> Laundry <input type="checkbox"/> Drying area <input type="checkbox"/> Sterilization <input type="checkbox"/> Doffing area <input type="checkbox"/> Waste area 1 <input type="checkbox"/> Waste area 2 <input type="checkbox"/> Personal rest area <input type="checkbox"/> Mortuary store <input type="checkbox"/> Transfer of deceased patients <input type="checkbox"/> Visitors and relative's area <input type="checkbox"/> Waste management area <input type="checkbox"/> Sterilization room <input type="checkbox"/> Bathroom	<p>High supervision (Module of 20 beds)</p> <input type="checkbox"/> Wards <input type="checkbox"/> Crash room <input type="checkbox"/> Discharge shower <input type="checkbox"/> Bathrooms
		<p>AREA 4 Other complementary areas</p>
		<input type="checkbox"/> Control and security points <input type="checkbox"/> Resting areas for staff <input type="checkbox"/> Kitchen <input type="checkbox"/> Living room <input type="checkbox"/> Parking <input type="checkbox"/> Visitor's area <input type="checkbox"/> Warehouse external

Access and routes: Entrances / exits / paths / zones

- Vehicle access: ambulances / logistics / personnel / visits
- People paths: patients / staff / visitors
- Equipment path: contaminated / uncontaminated
- Waste path
- Signage

2. Technical program

Inspection of technical infrastructure

- Structural system
- Construction system
- Water system
 - Storage
 - Treatment
 - Distribution system
 - Water points
- Sanitation and hygiene system
 - WC
 - Showers
 - Drainage grey water
 - Drainage black water

- Waste management
 - General wate
 - Infectious wate
 - Sharp waste
 - Treatment technology
- Electricity and lighting system
- Fire prevention and extinguishing system
- Telecommunication system
- Medical equipment
- Laboratory equipment
- Oxygen system
- Furniture

3. Implementation needs

- Physical and technical definition (drawings and documentation)
- Human resources
- Materials resources and tools
- Timeline
- Budget
- Conservation and maintenance program

Annex 5 Criteria for the reuse of the spaces

Spaces for reuse in and install COVID19 community facilities and Treatment Centers

Location	<ul style="list-style-type: none"> ▪ Strategic location, close or well communicated with the health system. ▪ Strategic location in relation with urban hubs. ▪ Communications: accessible for pedestrian and vehicles. Roads and perimetral space appropriate for ambulances and trucks. Connection with public transport. ▪ Avoid being close of other crowds' places (markets, schools, etc.)
Relevant characteristics	<ul style="list-style-type: none"> ▪ Flexibility: capacity to adapt the space for different uses. ▪ Wide spaces: big spaces (wide and high ceiling) without obstacles. ▪ Accessibility: Entries, circuits and spaces accessible for population. ▪ IPC friendly. ▪ Parking: areas for vehicles or logistic uses. ▪ Storage: areas to store safety and in good conditions (clod, dry, clean) different items: medical, logistic, technical. ▪ Comfort: Places with comfortable places to work, offices, rooms, outdoor places.

	<ul style="list-style-type: none"> ▪ Privacy: Possible areas for private activities (meetings, rest, psychological support, etc). ▪ Roofing: Consider if the place is cover or in case of not, if could be. ▪ Floor: A proper material on the floor to cleaning and disinfect and maintenance. ▪ Materials: The surfaces can be easily cleaning and disinfected. ▪ Support areas and services: laundry, kitchen, security, maintenance, etc.
Facilities	<ul style="list-style-type: none"> ▪ To consider the state of existing facilities: <ul style="list-style-type: none"> – Water (quantity and quality) – Sanitation: drainage grey and black water – Toilettes and showers – Electricity and illumination – Communication – Area for waste management – Fire system – Climatization – Security ▪ To have the possibility to install new facilities: WC, showers, kitchen, etc ▪ To consider installing other systems: medical equipment (Oxygen, X-Ray, call for nurses) ▪ To consider increasing the existing facilities: Waste, Electricity, Fire system, etc.
Comfort condition	<ul style="list-style-type: none"> ▪ To consider the control and improvement of: <ul style="list-style-type: none"> – Ventilation system (natural and forced) – Renovation and air flow – Temperature – Humidity – Illumination – Noises
Others	<ul style="list-style-type: none"> ▪ Impact of the use of the building in medium and long term. ▪ Capacity to adapt systems and dismantle without harm the building. ▪ Capacity to give accommodation for staff in case if needed. ▪ Human resources: companies or assembly teams with which they are used to assemble and disassemble, laundry service, catering service, security service, etc. ▪ Community acceptance.

Recommendable places and characteristics:

	Main advantages	Main disadvantages
Exhibitions halls Congress venues Events places	Communication Logistics Extra support services	To add new systems or facilities
Sport pavilion	Location Communication	Size can be not enough
Stadiums Sport fields	Size IPC friendly	Lack of roofing Floor not appropriate

Hotels Resorts	Comfort Extra support services	No visual control for the staff No IPC friendly No good conditions for logistic
Warehouses	Big space Easily adaptable Easily to implement facilities	Location No comfort condition
Airports and ports	Big size Good communications Extra support services	Location

	Location	Size	Physical characteristic	Flexibility	Facilities	IPC friendly	Logistic characteristics	Comfort
Exhibitions halls Congress venues Events places								
Sport pavilion								
Stadiums Sport fields								
Hotels Resorts								
Warehouses								
Airports and ports								